

#16 Instructions.Ovation

ABOVE CEILING BALLAST ACCESS*

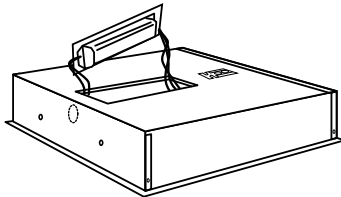

- 1.) Remove screw at one end of ballast access plate.
- 2.) Slip ballast access plate free of housing retention slots and lift out to reveal ballast.
- 3.) Remove ballast from plate by removing ballast mounting screw and slipping ballast free of retention slots.

* Above ceiling ballast access not available for multi-ballast, T5 or emergency-lighting models.

BELOW CEILING BALLAST ACCESS*

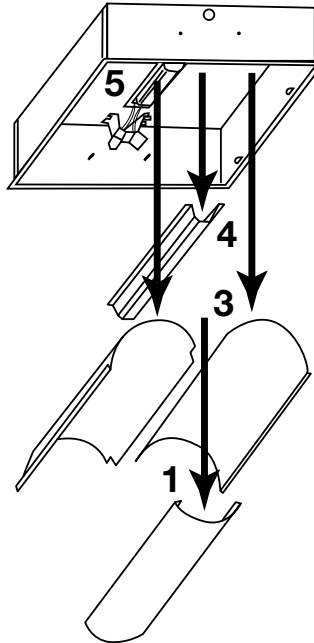

- 1.) Remove perforated lamp shield(s) by shifting of of mounting bolts.
- 2.) Remove lamps.
- 3.) Remove main reflector(s).
- 4.) Remove ballast channel cover (center-mount models only).
- 5.) Remove ballast(s) by removing ballast mounting screw and slipping ballast free of retention slots.

* Illustration shows Center-Mount model. Slide-Mount models have two perforated lamp shields, one main reflector (retained with screws to each side), and no channel cover. Ballast access sequence remains the same.



WARNING: RISK OF FIRE AND ELECTRIC SHOCK. THIS PRODUCT IS TO BE INSTALLED BY A QUALIFIED ELECTRICIAN ONLY.

ATTENTION: CONTRACTOR

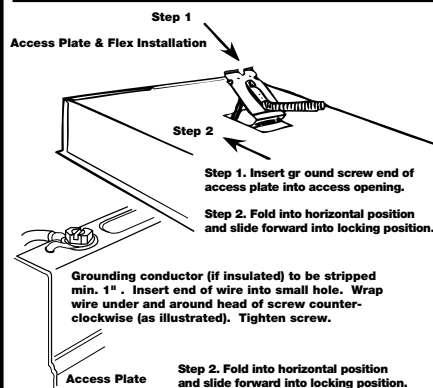

ATTENTION: RECEIVING DEPARTMENT

NOTE ACTUAL FIXTURE DESCRIPTION OF ANY SHORTAGE OR NOTICEABLE DAMAGE ON DELIVERY RECEIPT. FILE CLAIM FOR COMMON CARRIER (LTL) DIRECTLY WITH CARRIER. CLAIMS FOR CONCEALED DAMAGE MUST BE FILED WITHIN 15 DAYS OF DELIVERY. ALL DAMAGED MATERIAL, COMPLETE WITH ORIGINAL PACKING MUST BE RETAINED.

ATTENTION: CONTRACTOR

REMOVE PLASTIC BAGS AND PROTECTIVE COATINGS FROM REFLECTORS PRIOR TO ENERGIZING FIXTURES

LAMP ACCESS

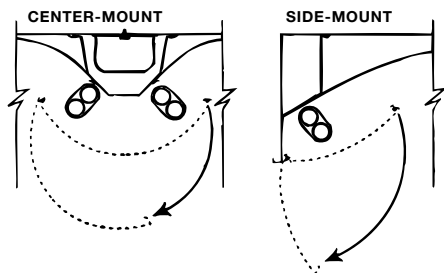

Access lamps by shifting perforated lamp shields off of mounting bolts on one side. Allow lamp shield to hinge from opposite mounting bolts, swinging downward to hang as shown.

