

# BC, BLB, BUB, BT, BUBXL mogul bodies, covers and gaskets

## Applications:

Mogul bodies are installed in conduit systems to:

- Act as pull outlets for conductors that are stiff, due to large size or type of insulation
- Provide the longer openings needed when pulling large conductors
- Prevent sharp bends and kinks in large conductors (protects insulation during installation)
- Provide ample openings for splices and taps
- Provide access to wiring for maintenance and future system changes

## Features:

Mogul bodies have:

- Long openings
- Provision for easy bends
- Taper tapped hubs with integral bushings
- Stainless steel cover screws
- Covers are designed with integral gasket
- SnapPack option – completely assembled with cover, gasket and captive stainless steel screws

BUBXL moguls with rollers:

- Larger internal volume provides additional space for bending and pulling large conductors (complies with the 6X wire bending rule)
- Rollers improve the ability to pull larger conductors and protect the insulation when the wire is being pulled, greatly reducing cut cable incidents
- Cover design takes less time to install and can be used as a solid or with the center removed for more internal volume

## Certifications and compliances:

- UL standard: 514B
- Fed. Spec.: W-C-586d
- CSA standard: C22.2 No. 18

## Standard material:

- Feraloy iron alloy

## Standard finish:

- Feraloy – electrogalvanized and aluminum acrylic paint

## Options:

- | Description                                 | Suffix    |
|---|-----------|
| • Material – copper-free aluminum .....     | <b>SA</b> |
| <i>Available in select shapes and sizes</i> |           |
| • SnapPack assembly .....                   | <b>CG</b> |

## Ordering information:

### BC



Hub size	Cat. #
1"	BC3 <sup>B</sup>
1 1/4"	BC4 <sup>B</sup>
1 1/2"	BC5 <sup>B</sup>
2"	BC6 <sup>B</sup>
2 1/2"	BC7 <sup>B</sup>
3"	BC8 <sup>B</sup>
3 1/2"	BC9 <sup>B</sup>
4"	BC10 <sup>B</sup>

### BUB



Hub size	Cat. #
1"	BUB3 <sup>B</sup>
1 1/4"	BUB4
1 1/2"	BUB5 <sup>B</sup>
2"	BUB6 <sup>B</sup>
2 1/2"	BUB7 <sup>B</sup>
3"	BUB8 <sup>B</sup>
3 1/2"	BUB9 <sup>B</sup>
4"	BUB10 <sup>B</sup>

### BUBXL (extra large) With cover and gasket



Hub size	Cat. #
2"	BUBXL6
3"	BUBXL8

### BLB<sup>A</sup>



Hub size	Cat. #
1"	BLB3
1 1/4"	BLB4
1 1/2"	BLB5
2"	BLB6 <sup>B</sup>
2 1/2"	BLB7
3"	BLB8
3 1/2"	BLB9 <sup>B</sup>
4"	BLB10 <sup>B</sup>

### BT



Hub size	Cat. #
1"	BT3
1 1/4"	BT4
1 1/2"	BT5 <sup>B</sup>
2"	BT6 <sup>B</sup>
2 1/2"	BT7
3"	BT8
3 1/2"	BT9 <sup>B</sup>
4"	BT10 <sup>B</sup>

### Blank replacement covers



Feraloy iron alloy (all B series moguls except BUBXL)

Size	Cat. # With round neoprene gasket
1" or 1 1/4"	BG48
1 1/2" or 2"	BG68
2 1/2" or 3"	BG88
3 1/2" or 4"	BG98

<sup>A</sup>For 5" size, use catalog number LBD012. For 6" size, use catalog number LBD014.

<sup>B</sup>Available in aluminum.

# BC, BLB, BUB, BT, BUBXL mogul bodies, covers and gaskets

## Dimensions (in inches):

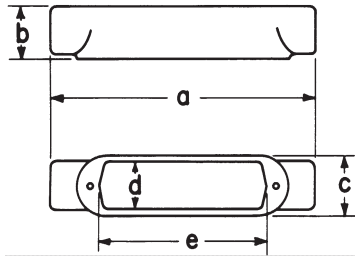

BC

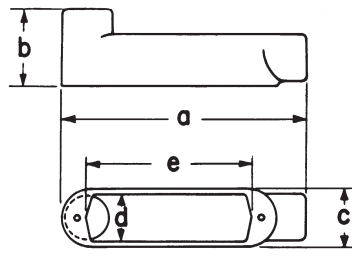

BLB

### BC

Hub size	1"	1¼"	1½"	2"	2½"	3"	3½"	4"
a	9 <sup>9</sup> / <sub>16</sub>	9 <sup>9</sup> / <sub>16</sub>	13 <sup>3</sup> / <sub>4</sub>	13 <sup>3</sup> / <sub>4</sub>	18 <sup>3</sup> / <sub>8</sub>	18 <sup>3</sup> / <sub>8</sub>	23 <sup>3</sup> / <sub>4</sub>	23 <sup>3</sup> / <sub>4</sub>
b	1 <sup>1</sup> / <sub>8</sub>	2 <sup>2</sup> / <sub>16</sub>	2 <sup>2</sup> / <sub>16</sub>	3 <sup>1</sup> / <sub>8</sub>	3 <sup>3</sup> / <sub>8</sub>	4 <sup>3</sup> / <sub>8</sub>	4 <sup>7</sup> / <sub>8</sub>	5 <sup>3</sup> / <sub>8</sub>
c	2 <sup>2</sup> / <sub>16</sub>	2 <sup>2</sup> / <sub>16</sub>	3	3	4 <sup>1</sup> / <sub>4</sub>	4 <sup>1</sup> / <sub>4</sub>	5 <sup>1</sup> / <sub>4</sub>	5 <sup>1</sup> / <sub>4</sub>
d	1 <sup>1</sup> / <sub>8</sub>	1 <sup>1</sup> / <sub>8</sub>	2 <sup>2</sup> / <sub>8</sub>	2 <sup>2</sup> / <sub>8</sub>	3 <sup>13</sup> / <sub>16</sub>	3 <sup>13</sup> / <sub>16</sub>	4 <sup>3</sup> / <sub>4</sub>	4 <sup>3</sup> / <sub>4</sub>
e	6	6	10	10	15	15	20	20

### BLB

Hub size	1"	1¼"	1½"	2"	2½"	3"	3½"	4"
a	8 <sup>19</sup> / <sub>32</sub>	8 <sup>19</sup> / <sub>32</sub>	12 <sup>11</sup> / <sub>16</sub>	12 <sup>11</sup> / <sub>16</sub>	16 <sup>29</sup> / <sub>32</sub>	16 <sup>29</sup> / <sub>32</sub>	22 <sup>7</sup> / <sub>8</sub>	22 <sup>7</sup> / <sub>8</sub>
b	2 <sup>27</sup> / <sub>32</sub>	3 <sup>3</sup> / <sub>8</sub>	3 <sup>3</sup> / <sub>8</sub>	4 <sup>3</sup> / <sub>16</sub>	5 <sup>3</sup> / <sub>32</sub>	5 <sup>27</sup> / <sub>32</sub>	6 <sup>1</sup> / <sub>2</sub>	7
c	2 <sup>2</sup> / <sub>16</sub>	2 <sup>2</sup> / <sub>16</sub>	3	3	4 <sup>1</sup> / <sub>4</sub>	4 <sup>1</sup> / <sub>4</sub>	5 <sup>1</sup> / <sub>4</sub>	5 <sup>1</sup> / <sub>4</sub>
d	1 <sup>1</sup> / <sub>8</sub>	1 <sup>1</sup> / <sub>8</sub>	2 <sup>2</sup> / <sub>8</sub>	2 <sup>2</sup> / <sub>8</sub>	3 <sup>13</sup> / <sub>16</sub>	3 <sup>13</sup> / <sub>16</sub>	4 <sup>3</sup> / <sub>4</sub>	4 <sup>3</sup> / <sub>4</sub>
e	6	6	10	10	15	15	20	20

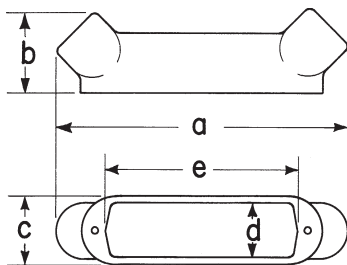

BUB

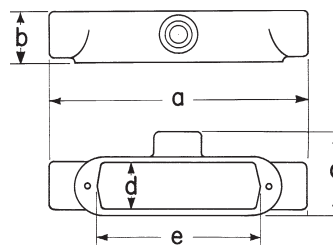

BT

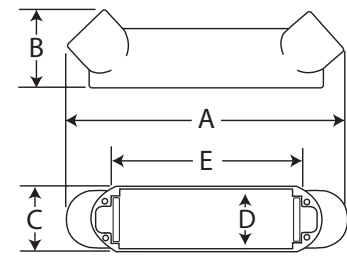

BUBXL

### BUB

Hub size	1"	1¼"	1½"	2"	2½"	3"	3½"	4"
a	9 <sup>9</sup> / <sub>16</sub>	9 <sup>9</sup> / <sub>16</sub>	13 <sup>1</sup> / <sub>2</sub>	13 <sup>1</sup> / <sub>2</sub>	17 <sup>3</sup> / <sub>4</sub>	17 <sup>7</sup> / <sub>8</sub>	23 <sup>3</sup> / <sub>8</sub>	23 <sup>3</sup> / <sub>4</sub>
b	2 <sup>1</sup> / <sub>16</sub>	3 <sup>3</sup> / <sub>16</sub>	3 <sup>1</sup> / <sub>2</sub>	4 <sup>1</sup> / <sub>8</sub>	4 <sup>13</sup> / <sub>16</sub>	5 <sup>5</sup> / <sub>8</sub>	6 <sup>3</sup> / <sub>8</sub>	6 <sup>13</sup> / <sub>16</sub>
c	2 <sup>2</sup> / <sub>16</sub>	2 <sup>2</sup> / <sub>16</sub>	3	3	4 <sup>1</sup> / <sub>4</sub>	4 <sup>1</sup> / <sub>4</sub>	5 <sup>1</sup> / <sub>4</sub>	5 <sup>1</sup> / <sub>4</sub>
d	1 <sup>1</sup> / <sub>8</sub>	1 <sup>1</sup> / <sub>8</sub>	2 <sup>2</sup> / <sub>8</sub>	2 <sup>2</sup> / <sub>8</sub>	3 <sup>13</sup> / <sub>16</sub>	3 <sup>13</sup> / <sub>16</sub>	4 <sup>3</sup> / <sub>4</sub>	4 <sup>3</sup> / <sub>4</sub>
e	6	6	10	10	15	15	20	20

### BUBXL

Hub size	2"	3"
a	15 <sup>7</sup> / <sub>25</sub>	22 <sup>17</sup> / <sub>20</sub>
b	4 <sup>7</sup> / <sub>100</sub>	5 <sup>29</sup> / <sub>50</sub>
c	3	4 <sup>1</sup> / <sub>4</sub>
d	2 <sup>1</sup> / <sub>4</sub>	3 <sup>19</sup> / <sub>50</sub>
e	12 <sup>1</sup> / <sub>4</sub>	15 <sup>1</sup> / <sub>4</sub>

### BT

Hub size	1"	1¼"	1½"	2"	2½"	3"	3½"	4"
a	9 <sup>9</sup> / <sub>16</sub>	9 <sup>9</sup> / <sub>16</sub>	13 <sup>3</sup> / <sub>4</sub>	13 <sup>3</sup> / <sub>4</sub>	18 <sup>3</sup> / <sub>8</sub>	18 <sup>3</sup> / <sub>8</sub>	23 <sup>3</sup> / <sub>4</sub>	23 <sup>3</sup> / <sub>4</sub>
b	1 <sup>1</sup> / <sub>8</sub>	2 <sup>2</sup> / <sub>16</sub>	2 <sup>2</sup> / <sub>16</sub>	3 <sup>1</sup> / <sub>8</sub>	3 <sup>3</sup> / <sub>8</sub>	4 <sup>3</sup> / <sub>8</sub>	4 <sup>7</sup> / <sub>8</sub>	5 <sup>3</sup> / <sub>8</sub>
c	3 <sup>5</sup> / <sub>32</sub>	3 <sup>3</sup> / <sub>32</sub>	4 <sup>1</sup> / <sub>16</sub>	4 <sup>1</sup> / <sub>16</sub>	5 <sup>19</sup> / <sub>32</sub>	5 <sup>23</sup> / <sub>32</sub>	6 <sup>7</sup> / <sub>8</sub>	6 <sup>7</sup> / <sub>8</sub>
d	1 <sup>1</sup> / <sub>8</sub>	1 <sup>1</sup> / <sub>8</sub>	2 <sup>2</sup> / <sub>8</sub>	2 <sup>2</sup> / <sub>8</sub>	3 <sup>13</sup> / <sub>16</sub>	3 <sup>13</sup> / <sub>16</sub>	4 <sup>3</sup> / <sub>4</sub>	4 <sup>3</sup> / <sub>4</sub>
e	6	6	10	10	15	15	20	20

# BC, BLB, BUB, BT, BUBXL mogul bodies, covers and gaskets – hot dip galvanized

## Applications:

Mogul bodies are installed in conduit systems to:

- Act as pull outlets for conductors that are stiff, due to large size or type of insulation
- Provide the longer openings needed when pulling large conductors
- Prevent sharp bends and kinks in large conductors (protects insulation during installation)
- Provide ample openings for splices and taps
- Provide access to wiring for maintenance and future system changes

## Features:

Mogul bodies have:

- Long openings
- Provision for easy bends
- Taper tapped hubs with integral bushings
- Stainless steel cover screws
- Covers with integral gasket are provided with bodies
- Pre-installed rollers on select shapes and sizes (LB and C shapes, 1½" to 4") to aid in wire pulling

BUBXL moguls with rollers:

- Larger internal volume provides additional space for bending and pulling large conductors (complies with the 6X wire bending rule)
- Rollers improve the ability to pull larger conductors and protect the insulation when the wire is being pulled, greatly reducing cut cable incidents
- Cover design takes less time to install and can be used as a solid or with the center removed for more internal volume
- Covers with integral gasket are provided with bodies

## Certifications and compliances:

- UL standard: 514B
- Fed. Spec.: W-C-586d
- CSA standard: C22.2 No. 18

## Standard material:

- Feraloy iron alloy

## Standard finish:

- Feraloy – hot dip galvanized

## Ordering information:

### BC



Hub size	Cat. #
1"	BC3 HDG CG
1¼"	BC4 HDG CG
1½"	BC5 HDG WR CG
2"	BC6 HDG WR CG
2½"	BC7 HDG WR CG
3"	BC8 HDG WR CG
3½"	BC9 HDG WR CG
4"	BC10 HDG WR CG

### BUB



Hub size	Cat. #
1"	BUB3 HDG CG
1¼"	BUB4 HDG CG
1½"	BUB5 HDG CG
2"	BUB6 HDG CG
2½"	BUB7 HDG CG
3"	BUB8 HDG CG
3½"	BUB9 HDG CG
4"	BUB10 HDG CG

### BUBXL (extra large) With cover and gasket



Hub size	Cat. #
2"	BUBXL6 HDG
3"	BUBXL8 HDG

### BLB<sup>ⓐ</sup>



Hub size	Cat. #
1"	BLB3 HDG CG
1¼"	BLB4 HDG CG
1½"	BLB5 HDG WR CG
2"	BLB6 HDG WR CG
2½"	BLB7 HDG WR CG
3"	BLB8 HDG WR CG
3½"	BLB9 HDG WR CG
4"	BLB10 HDG WR CG

### BT



Hub size	Cat. #
1"	BT3 HDG CG
1¼"	BT4 HDG CG
1½"	BT5 HDG CG
2"	BT6 HDG CG
2½"	BT7 HDG CG
3"	BT8 HDG CG
3½"	BT9 HDG CG
4"	BT10 HDG CG

## Blank replacement covers



Feraloy iron alloy (all B series moguls except BUBXL)

Size	Cat. # With round neoprene gasket
1" or 1¼"	BG48 HDG
1½" or 2"	BG68 HDG
2½" or 3"	BG88 HDG
3½" or 4"	BG98 HDG

<sup>ⓐ</sup>For 5" size, use catalog number LBD012. For 6" size, use catalog number LBD014.

# BC, BLB, BUB, BT, BUBXL mogul bodies, covers and gaskets – hot dip galvanized

## Dimensions (in inches):

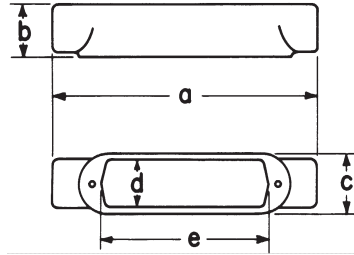

BC

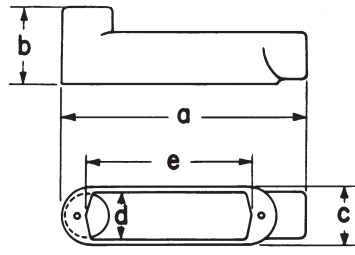

BLB

### BC

Hub size	1"	1 1/4"	1 1/2"	2"	2 1/2"	3"	3 1/2"	4"
a	9 <sup>9</sup> / <sub>16</sub>	9 <sup>9</sup> / <sub>16</sub>	13 <sup>3</sup> / <sub>4</sub>	13 <sup>3</sup> / <sub>4</sub>	18 <sup>3</sup> / <sub>8</sub>	18 <sup>3</sup> / <sub>8</sub>	23 <sup>3</sup> / <sub>4</sub>	23 <sup>3</sup> / <sub>4</sub>
b	1 <sup>7</sup> / <sub>8</sub>	2 <sup>5</sup> / <sub>16</sub>	2 <sup>9</sup> / <sub>16</sub>	3 <sup>1</sup> / <sub>8</sub>	3 <sup>5</sup> / <sub>8</sub>	4 <sup>3</sup> / <sub>8</sub>	4 <sup>7</sup> / <sub>8</sub>	5 <sup>3</sup> / <sub>8</sub>
c	2 <sup>7</sup> / <sub>16</sub>	2 <sup>7</sup> / <sub>16</sub>	3	3	4 <sup>1</sup> / <sub>4</sub>	4 <sup>1</sup> / <sub>4</sub>	5 <sup>1</sup> / <sub>4</sub>	5 <sup>1</sup> / <sub>4</sub>
d	1 <sup>7</sup> / <sub>8</sub>	1 <sup>7</sup> / <sub>8</sub>	2 <sup>5</sup> / <sub>8</sub>	2 <sup>5</sup> / <sub>8</sub>	3 <sup>13</sup> / <sub>16</sub>	3 <sup>13</sup> / <sub>16</sub>	4 <sup>3</sup> / <sub>4</sub>	4 <sup>3</sup> / <sub>4</sub>
e	6	6	10	10	15	15	20	20

### BLB

Hub size	1"	1 1/4"	1 1/2"	2"	2 1/2"	3"	3 1/2"	4"
a	8 <sup>19</sup> / <sub>32</sub>	8 <sup>19</sup> / <sub>32</sub>	12 <sup>11</sup> / <sub>16</sub>	12 <sup>11</sup> / <sub>16</sub>	16 <sup>29</sup> / <sub>32</sub>	16 <sup>29</sup> / <sub>32</sub>	22 <sup>7</sup> / <sub>8</sub>	22 <sup>7</sup> / <sub>8</sub>
b	2 <sup>27</sup> / <sub>32</sub>	3 <sup>3</sup> / <sub>32</sub>	3 <sup>5</sup> / <sub>8</sub>	4 <sup>3</sup> / <sub>16</sub>	5 <sup>3</sup> / <sub>32</sub>	5 <sup>27</sup> / <sub>32</sub>	6 <sup>1</sup> / <sub>2</sub>	7
c	2 <sup>7</sup> / <sub>16</sub>	2 <sup>7</sup> / <sub>16</sub>	3	3	4 <sup>1</sup> / <sub>4</sub>	4 <sup>1</sup> / <sub>4</sub>	5 <sup>1</sup> / <sub>4</sub>	5 <sup>1</sup> / <sub>4</sub>
d	1 <sup>7</sup> / <sub>8</sub>	1 <sup>7</sup> / <sub>8</sub>	2 <sup>5</sup> / <sub>8</sub>	2 <sup>5</sup> / <sub>8</sub>	3 <sup>13</sup> / <sub>16</sub>	3 <sup>13</sup> / <sub>16</sub>	4 <sup>3</sup> / <sub>4</sub>	4 <sup>3</sup> / <sub>4</sub>
e	6	6	10	10	15	15	20	20

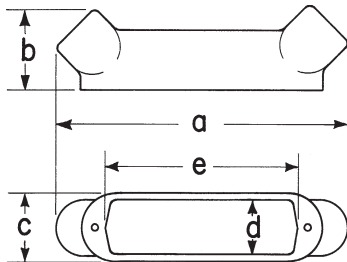

BUB

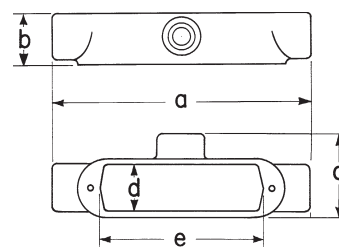

BT

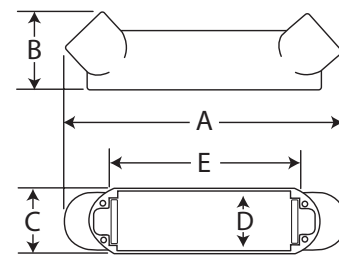

BUBXL

### BUB

Hub size	1"	1 1/4"	1 1/2"	2"	2 1/2"	3"	3 1/2"	4"
a	9 <sup>9</sup> / <sub>16</sub>	9 <sup>9</sup> / <sub>16</sub>	13 <sup>1</sup> / <sub>2</sub>	13 <sup>1</sup> / <sub>2</sub>	17 <sup>3</sup> / <sub>4</sub>	17 <sup>7</sup> / <sub>8</sub>	23 <sup>3</sup> / <sub>8</sub>	23 <sup>3</sup> / <sub>4</sub>
b	2 <sup>1</sup> / <sub>16</sub>	3 <sup>3</sup> / <sub>16</sub>	3 <sup>1</sup> / <sub>2</sub>	4 <sup>1</sup> / <sub>8</sub>	4 <sup>13</sup> / <sub>16</sub>	5 <sup>5</sup> / <sub>8</sub>	6 <sup>3</sup> / <sub>8</sub>	6 <sup>13</sup> / <sub>16</sub>
c	2 <sup>7</sup> / <sub>16</sub>	2 <sup>7</sup> / <sub>16</sub>	3	3	4 <sup>1</sup> / <sub>4</sub>	4 <sup>1</sup> / <sub>4</sub>	5 <sup>1</sup> / <sub>4</sub>	5 <sup>1</sup> / <sub>4</sub>
d	1 <sup>7</sup> / <sub>8</sub>	1 <sup>7</sup> / <sub>8</sub>	2 <sup>5</sup> / <sub>8</sub>	2 <sup>5</sup> / <sub>8</sub>	3 <sup>13</sup> / <sub>16</sub>	3 <sup>13</sup> / <sub>16</sub>	4 <sup>3</sup> / <sub>4</sub>	4 <sup>3</sup> / <sub>4</sub>
e	6	6	10	10	15	15	20	20

### BUBXL

Hub size	2"	3"
a	15 <sup>7</sup> / <sub>25</sub>	22 <sup>17</sup> / <sub>20</sub>
b	4 <sup>7</sup> / <sub>100</sub>	5 <sup>29</sup> / <sub>50</sub>
c	3	4 <sup>1</sup> / <sub>4</sub>
d	2 <sup>1</sup> / <sub>4</sub>	3 <sup>19</sup> / <sub>50</sub>
e	12 <sup>1</sup> / <sub>4</sub>	15 <sup>1</sup> / <sub>4</sub>

### BT

Hub size	1"	1 1/4"	1 1/2"	2"	2 1/2"	3"	3 1/2"	4"
a	9 <sup>9</sup> / <sub>16</sub>	9 <sup>9</sup> / <sub>16</sub>	13 <sup>3</sup> / <sub>4</sub>	13 <sup>3</sup> / <sub>4</sub>	18 <sup>3</sup> / <sub>8</sub>	18 <sup>3</sup> / <sub>8</sub>	23 <sup>3</sup> / <sub>4</sub>	23 <sup>3</sup> / <sub>4</sub>
b	1 <sup>7</sup> / <sub>8</sub>	2 <sup>5</sup> / <sub>16</sub>	2 <sup>9</sup> / <sub>16</sub>	3 <sup>1</sup> / <sub>8</sub>	3 <sup>5</sup> / <sub>8</sub>	4 <sup>3</sup> / <sub>8</sub>	4 <sup>7</sup> / <sub>8</sub>	5 <sup>3</sup> / <sub>8</sub>
c	3 <sup>5</sup> / <sub>32</sub>	3 <sup>3</sup> / <sub>32</sub>	4 <sup>1</sup> / <sub>16</sub>	4 <sup>1</sup> / <sub>16</sub>	5 <sup>19</sup> / <sub>32</sub>	5 <sup>23</sup> / <sub>32</sub>	6 <sup>3</sup> / <sub>8</sub>	6 <sup>3</sup> / <sub>8</sub>
d	1 <sup>7</sup> / <sub>8</sub>	1 <sup>7</sup> / <sub>8</sub>	2 <sup>5</sup> / <sub>8</sub>	2 <sup>5</sup> / <sub>8</sub>	3 <sup>13</sup> / <sub>16</sub>	3 <sup>13</sup> / <sub>16</sub>	4 <sup>3</sup> / <sub>4</sub>	4 <sup>3</sup> / <sub>4</sub>
e	6	6	10	10	15	15	20	20