

Hazard-Gard EVLPPF compact fluorescent luminaires

Cl. I, Div. 1, Groups B (with suffix GB), C, D
Cl. I, Zone 1, Groups IIB + H₂ (with suffix GB), IIB, IIA
Cl. II, Div. 1, Groups E, F, G
Cl. III & Simultaneous Presence

Marine & Wet Locations
3, 3R, 4, 4X; IP66

4L

Applications:

Hazard-Gard® EVLPPF low profile luminaires are used in:

- Areas where flammable or explosive vapors or gases are present
- Hazardous areas, both indoors and outdoors, where long life and low maintenance costs are desired
- Petroleum refineries, chemical, petrochemical and pharmaceutical plants, oil terminals, gas plants and other heavy process industry facilities
- Waste treatment facilities
- Drilling platforms and other coastal and offshore hazardous areas

Features:

- Small, compact size
- Two start Acme threaded construction
- Lightweight copper-free aluminum housing with powdered epoxy finish
- All exterior hardware is corrosion-resistant stainless steel
- Four mounting arrangements – pendant, ceiling, wall bracket and stanchion
- Wide range of light sources and wattages
- Marine and NEMA 4X construction
- Integral ballast
- High power factor (90%+) ballasts
- Uses same mounting modules as the standard Hazard-Gard
- Internally fluted glass globes
- Krydon construction dome and angle reflectors – won't rust, corrode, dent, chip or peel
- Now available in components – luminaire body, mounting module, guard, reflectors
- Three-wire construction is standard on fluorescent emergency lighting
- Perfect where low mounting restrictions are a concern
- Easier assembly, installation and maintenance
- Superior corrosion resistance
- Suits any lighting layout
- Meets specific lighting needs
- Outdoor, hose down, marine and corrosive environments suitable
- Lowest installed cost
- Allows more luminaires per circuit
- Easy retrofitting when the EVLPPF is the preferred choice
- Reduces glare and distributes light evenly – ideal for adverse environments typical of industrial facilities
- For energy conservation, luminaires can be switched off without affecting the emergency operation feature



Certifications and compliances:

NEC/CEC:

- Class I, Division 1, Groups B (with suffix GB), C, D
- Class I, Zone 1, Groups IIB + H₂ (with suffix GB), IIB, IIA
- Class II, Class III & Simultaneous Presence (Class I and Class II)

UL standards:

- UL844 – Hazardous (Classified) Locations
- UL1598 – Luminaires
- UL1598A – Marine Locations

CSA standard:

- C22.2 No. 137

Standard materials:

- Mounting modules, cover, ballast housing, globe holder – copper-free aluminum
- Globe – heat- and impact-resistant glass
- Exterior hardware – stainless steel
- Reflectors (dome and angle) – Krydon fiberglass-reinforced polyester
- Guard – stainless steel

Standard finishes:

- Copper-free aluminum – Corro-free epoxy powder coat
- Krydon – high reflectance white

Electrical ratings:

Sources/wattage:

- 52W (two 26W lamps); 64W (two 32W lamps)
- 120-277V, 50-60 Hz
- 347V, 60 Hz

Conduit entries:

- 3/4", 1" NPT – pendant, wall bracket, ceiling mount
- 1 1/4" NPT – stanchion mount

Photometrics:

- Refer to www.eaton.com (under the Resources tab of each product family) for specific photometric IES files

Options:

Description	Suffix
• Group B suitability	GB
• Fused	S658
<i>Not suitable for marine applications</i>	
• Factory assembled with lamps	FA

Accessories (ordered separately):

Description	Cat. #
• Dome reflector	RD739
• Angle reflector	RA739
• Exit sign	DMVF-EXD

Hazard-Gard EVLPF compact fluorescent luminaires

Cl. I, Div. 1, Groups B
(with suffix GB), C, D
Cl. I, Zone 1, Groups IIB + H₂
(with suffix GB), IIB, IIA
Cl. II, Div. 1, Groups E, F, G
Cl. III & Simultaneous Presence

Marine & Wet Locations
3, 3R, 4, 4X; IP66

4L

Ordering information:



Pendant mount

		Pendant	Wall bracket ^A	Ceiling ^A	Stanchion	Luminaire body less mounting module and guard
Watts	Hub size	Cat. # With guard	Cat. # With guard	Cat. # With guard	Cat. # With guard	
Fluorescent – high power factor ballast (min. P.F. 90%)						
52	3/4"	EVLPPFA02521	EVLPPFBX02521	EVLPPFCX02521		EVLPPF0520
	1"	EVLPPFA03521	EVLPPFBX03521	EVLPPFCX03521		
	1 1/4"				EVLPPFJ04521	
64	3/4"	EVLPPFA02641	EVLPPFBX02641	EVLPPFCX02641		EVLPPF0640
	1"	EVLPPFA03641	EVLPPFBX03641	EVLPPFCX03641		
	1 1/4"				EVLPPFJ04641	



Wall bracket
mount^A

		Pendant	Wall bracket ^A	Ceiling ^A	Stanchion
Watts	Hub size	Cat. # Without guard	Cat. # Without guard	Cat. # Without guard	Cat. # Without guard
Fluorescent – high power factor ballast (min. P.F. 90%)					
52	3/4"	EVLPPFA02520	EVLPPFBX02520	EVLPPFCX02520	
	1"	EVLPPFA03520	EVLPPFBX03520	EVLPPFCX03520	
	1 1/4"				EVLPPFJ04520
64	3/4"	EVLPPFA02640	EVLPPFBX02640	EVLPPFCX02640	
	1"	EVLPPFA03640	EVLPPFBX03640	EVLPPFCX03640	
	1 1/4"				EVLPPFJ04640

Complete catalog number as follows:

Standard voltage ballasts

	NEC/UL and CEC/CSA (cUL)	CEC/CSA (cUL)
Voltage	120-277V, 50/60 Hz	347V, 60 Hz
Suffix	/UNV	/347



Ceiling mount^A



Stanchion mount

^A Ceiling and wall bracket mounts have four hubs; three are plugged.

Hazard-Gard EVLPPF

compact fluorescent luminaires

Ordering by components

Cl. I, Div. 1, Groups B
(with suffix GB), C, D
Cl. I, Zone 1, Groups IIB + H₂
(with suffix GB), IIB, IIA
Cl. II, Div. 1, Groups E, F, G
Cl. III & Simultaneous Presence

4L

EVLPPF luminaires are available in components.

A complete luminaire consists of:

- I. Mounting module
- II. Luminaire body
- III. Guard, reflector or exit sign

Mounting modules:

Type	Conduit size	Cat. #
Pendant mount	3/4"	EVMP2
	1"	EVMP3
Ceiling mount and wall box	3/4"	EV22
	1"	EV33
Wall bracket arm	Use EV22 or EV33 box with EV87	EV87
Stanchion mount	1 1/4"	EVMJ4
Guard:		
Fluorescent		EV512
Reflectors:		
Dome		RD739
Angle		RA739

Family tree:

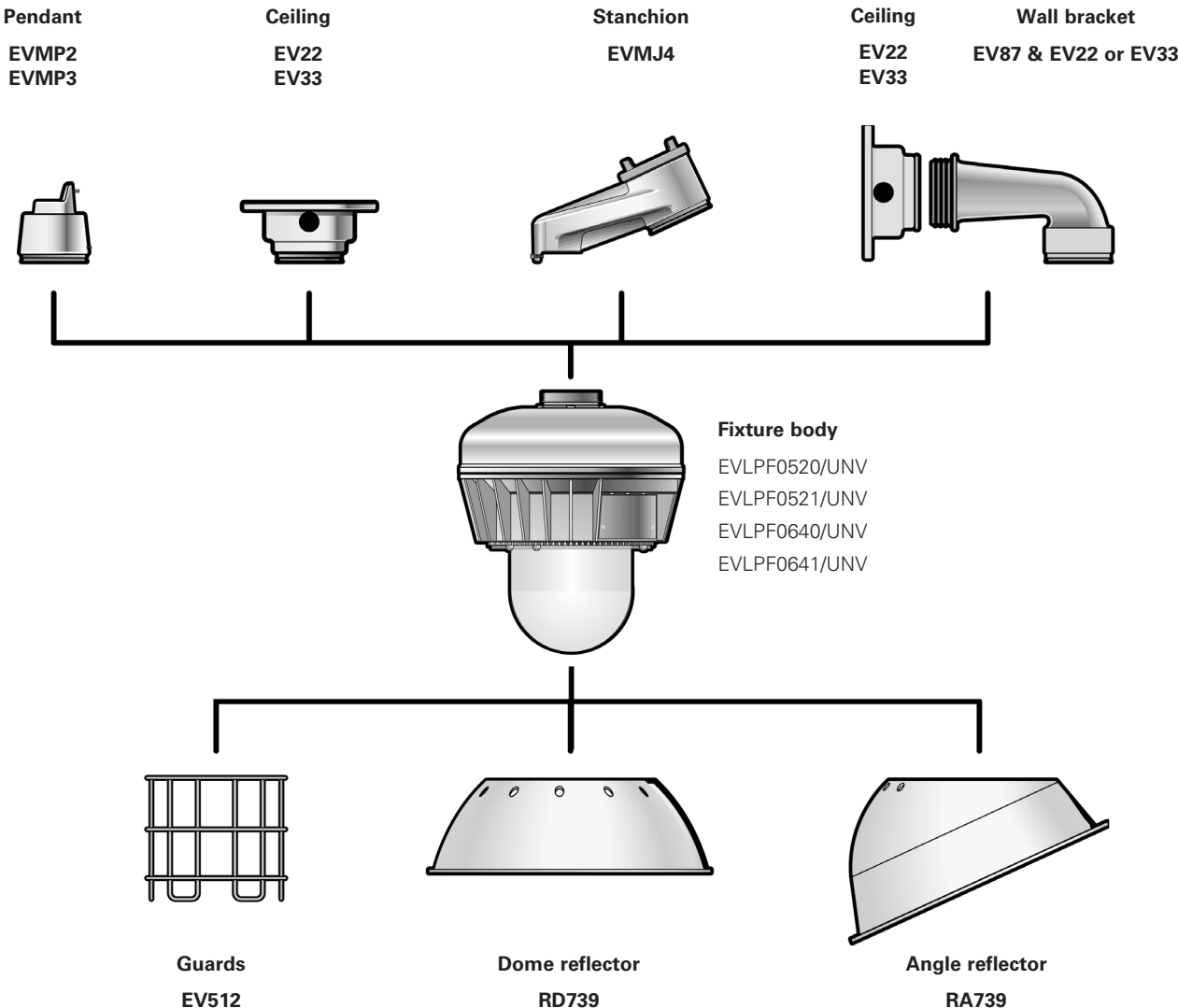

Hazard-Gard EVLPPF compact fluorescent luminaires

Cl. I, Div. 1, Groups B
(with suffix GB), C, D
Cl. I, Zone 1, Groups IIB + H₂
(with suffix GB), IIB, IIA
Cl. II, Div. 1, Groups E, F, G
Cl. III & Simultaneous Presence

Marine & Wet Locations
3, 3R, 4, 4X; IP66

4L

Temperature performance data:

Type	Watts	Minimum operating temp.	Class I, Groups B (with suffix GB), C, D; Class I, Zone 1	Class II, Groups E, F, G; Class III; Simultaneous Presence	Supply wire °C
			40°C	40°C	
Fluorescent	52	-18°C	T6	T6	75
	64	-18°C	T6	T6	75

Dimensions (in inches):

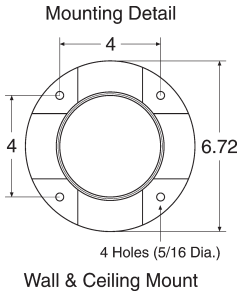
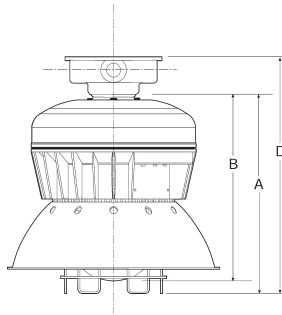
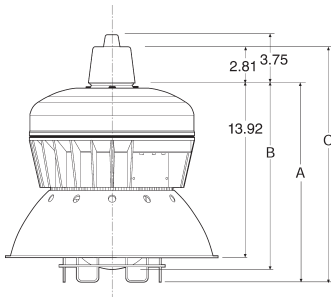
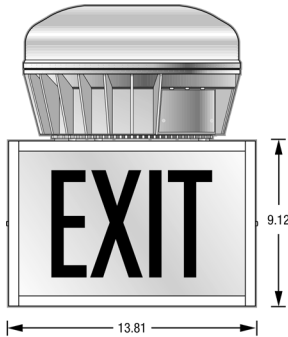
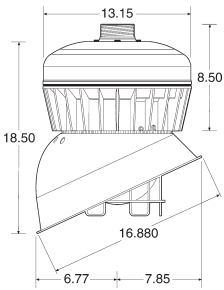
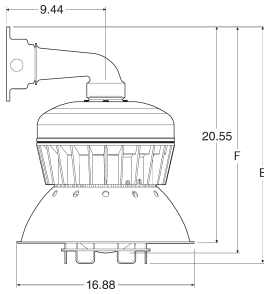
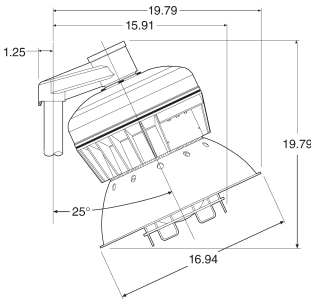

Type	A	B	C	D	E	F
Fluorescent	15.69	14.69	18.25	18.46	22.34	21.30

Net luminaire weights:

Type	Weight (lbs.)
Fluorescent	31.50

Type	Weight (lbs.)
Add mounting modules:	
Pendant	1.00
Ceiling	2.00
Bracket	4.50
Stanchion	2.50
Add reflectors and exit sign:	
Dome	1.00
Angle	1.00
Exit sign (DMVF-EXD)	5.00

Deduct: 0.50 lbs. for wire guard