

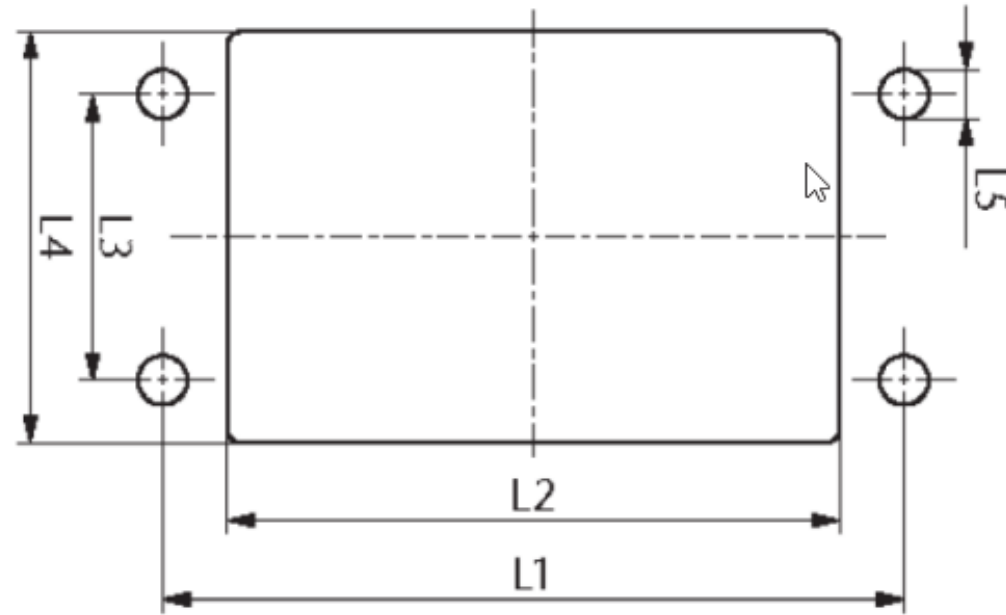

Cable Entry Systems

Cable Entry Gland Plate Connected Locking Inside, CCFLI



Cutout Dimensions

Frame	Catalog Number	L1 (mm/in.)	L2 (mm/in.)	L3 (mm/in.)	L4 (mm/in.)	L5 (mm/in.)
Locking frame for CCFI14	CCFLI14	58/2.28	46/1.81	32/1.26	46/1.81	5.5/.22
Locking frame for CCFI610	CCFLI610	83/3.27	68.5/2.70	32/1.26	46/1.81	5.5/.22
Locking frame for CCFI816	CCFLI816	103/4.06	91/3.58	32/1.26	46/1.81	5.5/.22
Locking frame for CCFI1024	CCFLI1024	130/5.12	113.5/4.47	32/1.26	46/1.81	5.5/.22

Combination Options

Frame	INLAY			
	1	2	4	6
	CCFD1	CCFD2	CCFD4	CCFD6
Locking frame for CCFI14	x	x	x	
Locking frame for CCFI610	x	x	x	x
Locking frame for CCFI816	x	x	x	x
Locking frame for CCFI1024	x	x	x	x

1

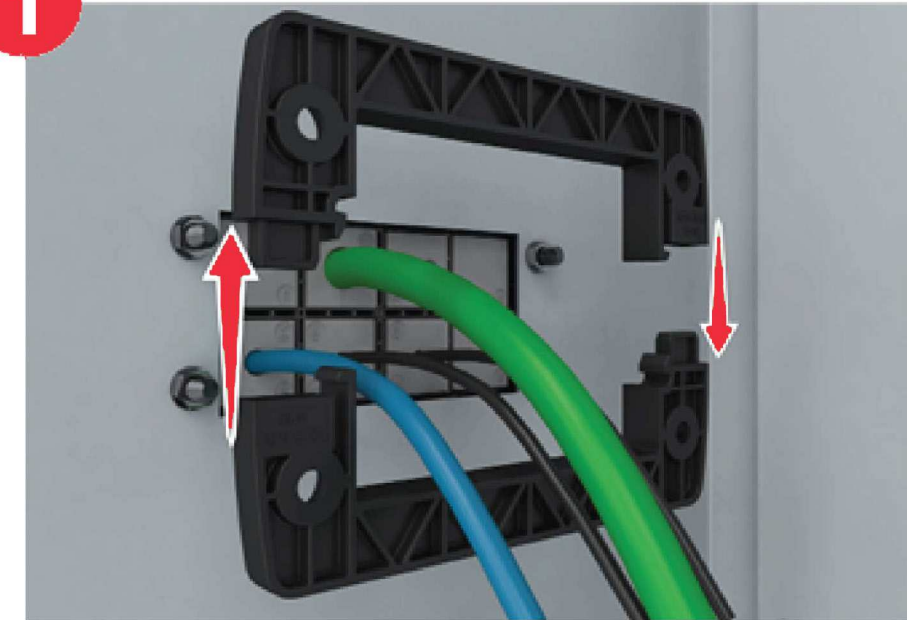

Push the 2 sections together until both ends snap together.

2

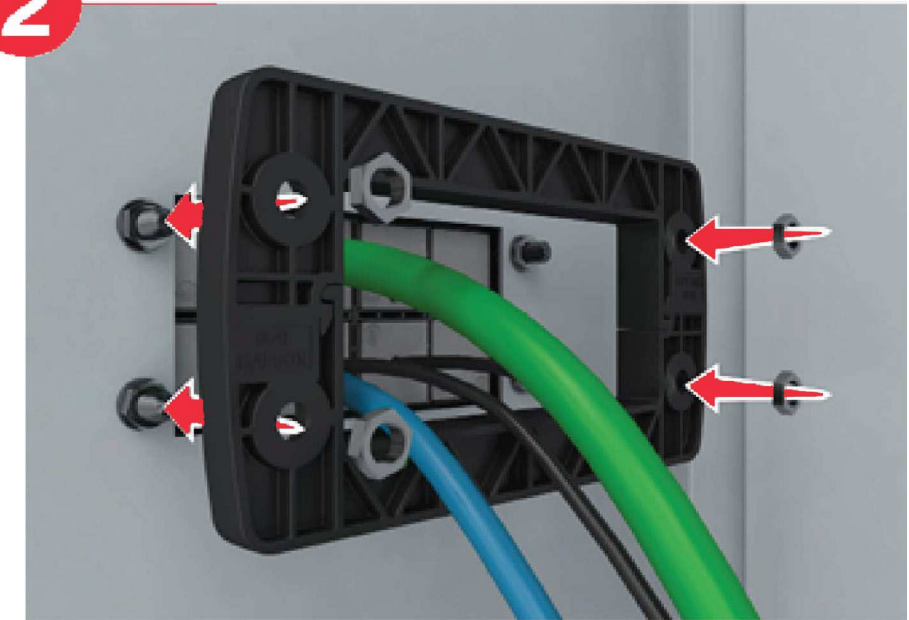

Fasten with 4 hex nuts tightening to 3 Nm (26 in-lbs).



According to UL Standard 508A, the following Conditions of Acceptability apply:

- Use M5 screws of stainless steel (AISI type 304 or 316)
- Max. end-use temperature for UL application is 50° C (52° F)
- Max. temperature range: -40° C to 120° C (-40° to 248° F) static