

# LED/CFL/Incandescent Rotary Dimmer

Single Pole (One Location)

Cat. No. RNL06

600W Incandescent, 150W Dimmable LED & CFL

120VAC, 60Hz

## INSTALLATION INSTRUCTIONS



DI-000-RNL06-02A

### WARNINGS AND CAUTIONS:

- **TO AVOID FIRE, SHOCK, OR DEATH: TURN OFF POWER** at circuit breaker or fuse and test that power is off before wiring!
- To avoid overheating and possible damage to this device and other equipment, **DO NOT** install to control a receptacle, fluorescent lighting, a motor or a transformer-operated appliance.
- To be installed and/or used in accordance with appropriate electrical codes and regulations.
- If you are unsure about any part of these instructions, consult an electrician.
- Use this device with **copper or copper clad wire only**.

### WARNINGS AND CAUTIONS:

- Use only one (1) dimmer in a 3 or 4-way circuit. The switch(es) will turn the light on at the brightness level selected at the dimmer.
- Use with compatible dimmable LED, CFL bulbs, incandescent or 120V halogen fixtures only. For a complete list of compatible LED and CFL bulbs refer to [www.leviton.com](http://www.leviton.com).
- When multiple bulbs are used with one dimmer **DO NOT** mix bulb types. All bulbs shall be either LED; CFL or incandescent. Using the same make/model of each bulb will enhance dimmer performance.
- **For use with 75 degree C minimum field wiring.**

### Tools needed to install your Dimmer

Slotted/Philips Screwdriver  
Pencil

Electrical Tape  
Cutters

Pliers  
Ruler

### Installing Dimmer by itself or with other devices

If installing the dimmer in a single device application, proceed to the **INSTALLING YOUR DIMMER** section. If installing multiple dimmers in a multi-gang wallbox configuration proceed as follows:

### MULTI-DEVICE APPLICATION:

In incandescent applications with multiple dimmers in the same wallbox a reduction of the dimmer's capacity is required. Refer to the chart below for the maximum load per dimmer. No derating is required for use in dimmable CFL or dimmable LED multi-device installations.

MAXIMUM LOAD PER DIMMER FOR MULTI-DEVICE			
Cat. No.	Single	Two Devices	More than 2 Devices
RNL06	600W	500W	400W

### INSTALLING YOUR DIMMER

**NOTE:** Use check boxes ☒ when steps are completed.

- Step 1** **WARNING: TO AVOID FIRE, SHOCK, OR DEATH; TURN OFF POWER** at circuit breaker or fuse and test that power is off before wiring!



Breaker Panel

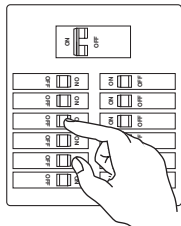

Fuse Panel

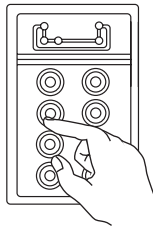

### Step 2 Removing existing switch:



Remove existing wallplate and switch mounting screws. Carefully pull switch from wall box. **DO NOT** remove wires attached to the switch at this time.

### Step 3 Identifying your wiring application (most common):



**NOTE:** If the wiring in the wall box does not resemble any of these configurations, consult an electrician.

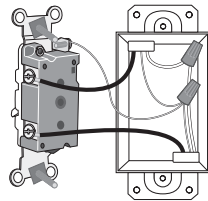

#### Single-Pole:

Look at the back of your switch. If there are 2 wires connected to two screw terminals (not including a green or bare copper wire used for grounding), you have a Single-Pole switch.

### Step 4 Preparing and connecting wires:



- Make sure that the ends of the wires from the wall box are **straight (cut if necessary)**.
- Remove 5/8" (1.6 cm) of insulation from each wire in the wall box (shown).

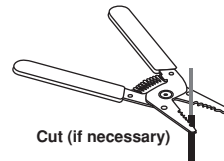

Cut (if necessary)



### Step 5 Single-Pole Wiring Application:

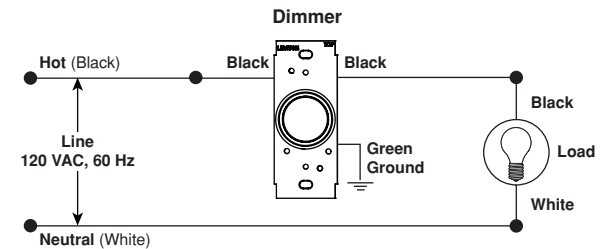
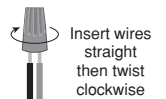
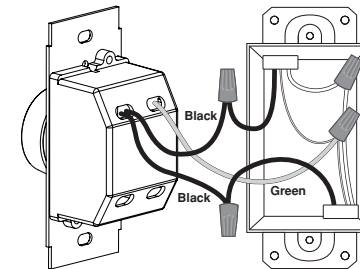

Connect wires per **WIRING DIAGRAM** as follows:

Screw wire connectors on clockwise making sure no bare conductors show below the wire connectors. Secure each connector with electrical tape.

- Green dimmer ground lead to green or bare copper wire in wall box.
- Black dimmer lead to any wall box wire removed from old switch.
- Remaining black dimmer lead to remaining wall box wire.
- **Proceed to Step 6.**

**For non-standard wiring applications, refer to Wire Connector and Number of Conductors Chart**

#### WIRE CONNECTOR / # OF COND. COMBINATION CHART

1- #12 w/ 1 to 3 #14, #16 or #18
2- #12 w/ 1 or 2 #16 or #18
1- #14 w/ 1 to 4 #16 or #18
2- #14 w/ 1 to 3 #16 or #18

## Step 6 Testing dimmer prior to mounting in wall box:



Cat. No. RNL06

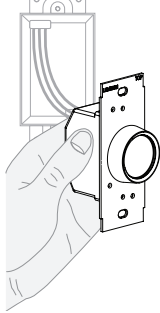

- Restore power at circuit breaker or fuse.
- Carefully holding dimmer as shown proceed as follows:  
Rotate knob clockwise to highest position (Lights should turn ON to brightest level).  
If lights do not turn ON, refer to the **TROUBLESHOOTING** section.

## OPERATION

**ON:** Rotate knob clockwise.  
(unit will click when it switches ON)

**OFF:** Rotate knob full counterclockwise.  
(unit will click when it switches OFF)

**BRIGHTEN:** Rotate knob clockwise.

**DIM:** Rotate knob counterclockwise.

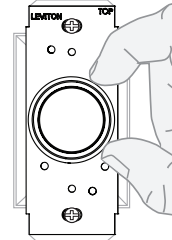

## TROUBLESHOOTING

- **Lights Flickering**
  - Lamp has a bad connection.
  - Wires not secured firmly with wire connectors.
- **CFL or LED bulb flickers throughout dimming range**
  - Please refer to recommended dimmable LED bulbs and CFL bulbs at [www.leviton.com](http://www.leviton.com).
- **Light does not turn ON**
  - Circuit breaker or fuse has tripped.
  - Lamp is burned out.
  - Lamp Neutral connection is not wired.

## Step 7 Dimmer Mounting:



**WARNING: TO AVOID FIRE, SHOCK, OR DEATH;  
TURN OFF POWER** at circuit breaker or fuse and test that power is off before mounting!

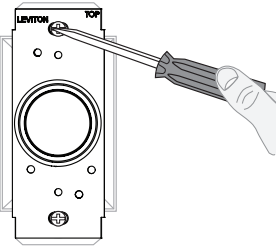

- Installation may now be completed by carefully positioning all wires to provide room in wall box the for dimmer.
- Mount dimmer into box with mounting screws supplied.
- Remove knob.
- Attach wallplate.
- Replace knob by aligning with the "D" shape of the rotary shaft.

## Step 8 Restore Power:



Restore power at circuit breaker or fuse.  
**Installation is complete.**

### FOR CANADA ONLY

For warranty information and/or product returns, residents of Canada should contact Leviton in writing at **Leviton Manufacturing of Canada Ltd to the attention of the Quality Assurance Department, 165 Hymus Blvd, Pointe-Claire (Quebec), Canada H9R 1E9** or by telephone at **1 800 405-5320**.

For Technical Assistance Call: **1-800-824-3005 (U.S.A. Only)**  
[www.leviton.com](http://www.leviton.com)

### LIMITED 2 YEAR WARRANTY AND EXCLUSIONS

Leviton warrants to the original consumer purchaser and not for the benefit of anyone else that this product at the time of its sale by Leviton is free of defects in materials and workmanship under normal and proper use for two years from the purchase date. Leviton's only obligation is to correct such defects by repair or replacement, at its option. **For details visit [www.leviton.com](http://www.leviton.com) or call 1-800-824-3005.** This warranty excludes and there is disclaimed liability for labor for removal of this product or reinstallation. This warranty is void if this product is installed improperly or in an improper environment, overloaded, misused, opened, abused, or altered in any manner, or is not used under normal operating conditions or not in accordance with any labels or instructions. **There are no other or implied warranties of any kind, including merchantability and fitness for a particular purpose,** but if any implied warranty is required by the applicable jurisdiction, the duration of any such implied warranty, including merchantability and fitness for a particular purpose, is limited to two years. **Leviton is not liable for incidental, indirect, special, or consequential damages, including without limitation, damage to, or loss of use of, any equipment, lost sales or profits or delay or failure to perform this warranty obligation.** The remedies provided herein are the exclusive remedies under this warranty, whether based on contract, tort or otherwise.