



Plasti-Bond REDH₂OT®

A New Level of Assurance

**Unmatched Performance.
Uncompromised Safety.**

The Plasti-Bond REDH₂OT line of explosion-proof fittings has always provided the highest possible performance and uncompromising safety – now we've raised that assurance to a whole new level.





**UL 1203 – SAFETY STANDARD FOR EXPLOSION-PROOF
AND DUST-IGNITION-PROOF ELECTRICAL EQUIPMENT
FOR USE IN HAZARDOUS (CLASSIFIED) LOCATIONS**

A Fitting Evolution

Our new, innovative upgrade to Plasti-Bond REDH₂OT's sealing fitting allows for a UL-required plug engagement verification by utilizing our P5SA™ feedback system for a proper installation without compromising critical corrosion protection. In addition, Plasti-Bond's Seal Offs, Conduit Unions, GUA Outlet Boxes and EC Flexible Couplings have all been certified to UL 1203 for safety through Underwriters Laboratories (UL), an industry first.

Hazardous Location Solutions

This unprecedented achievement, along with Plasti-Bond's proven performance with ETL-listed coated conduit, provides a comprehensive, corrosion-resistant solution for the installation of a completely verifiable raceway to deliver safe performance in hazardous areas.

Key Benefits

Failure Is Not An Option

Use of high-quality sealing fittings from Plasti-Bond provides protection against costly property damage, and more importantly, the right choice of explosion-proof products could be the difference in saving lives.

Functional Consistency

Maintains same UL area classification ratings as the uncoated product for consistency and conformity of design, installation and operation.

System Validation

UL testing validates the assembled system, providing customers an unprecedented level of assurance that they will have the best corrosion protection for safe performance as required in the harshest environments.

Installation Done Right The First Time

Precise coating of threads, quality control of protective coating thickness and P5SA™ plug installation verification on sealing fittings all allow for a level of assurance that installation will be performed correctly.

Performance Matters

As with all Plasti-Bond products, performance of static-free coatings, rigorous laboratory testing and regulated third-party verification guarantee long-term, safe operation of fittings in hazardous locations.

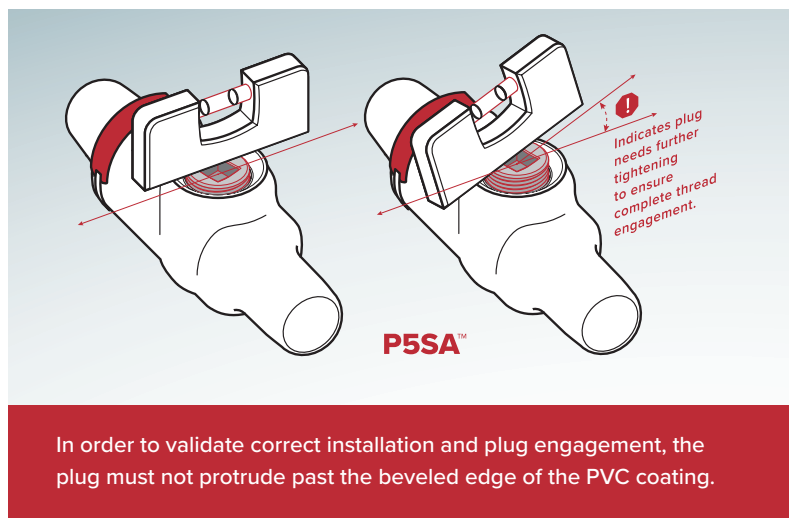

Product Features

CONDUIT UNIONS

MORE INFO



KEY BENEFITS

UL 1203 Listed

13 trade sizes from ½” to 6”

Connects to conduit fittings, junction boxes and device enclosures

Allows for future changes to conduit system

Compact design permits assembly with minimum clearance to other adjacent conduit and/or equipment

Strong and durable construction to protect the system in case of “pressure piling”

Sealing sleeves on all conduit openings

Specially formulated 40 mil PVC exterior coating with static-dissipative and flame-resistant properties

Specially formulated 2 mil urethane interior coating

SEALING FITTINGS

KEY BENEFITS

UL 1203 Listed

10 trade sizes from ½" to 4"

NEW FEATURE: P5SA™ Plug Verification System

Prevents gases, vapors or flames from migrating through conduit systems

Limits the potential for explosion

Strong and durable construction to protect the system in the case of "pressure piling"

Protects against corrosive atmospheres

Provides continual safety in hazardous locations

Specially formulated 40 mil PVC exterior coating with static-dissipative and flame-resistant properties

Specially formulated 2 mil urethane interior coating

MORE INFO

PG.
8



Product Features

GUA SERIES OUTLET BOXES

MORE INFO

PG.
12



KEY BENEFITS

UL 1203 Listed

Serves as pull-and-slice box, changes direction of conduit run and provides access to conductors

Strong and durable construction to protect the system in the case of “pressure piling”

Sealing sleeves on all conduit openings

Molded-in PVC seal preserves vent characteristics and seals out corrosives

Specially formulated 40 mil PVC exterior coating with static-dissipative and flame-resistant properties

Specially formulated 2 mil urethane interior coating

EC SERIES FLEXIBLE COUPLINGS

MORE INFO

PG.
16



KEY BENEFITS

UL 1203 Listed

Accomplishes difficult bends

Allows for movement and vibration of connected equipment

Rugged design to withstand explosive pressure and mechanical abuse

Liquid Tight for wet locations

Replaces rigid conduit when space is an issue

Wire duct liner insulates against grounds and burn-through

Option of two threaded male end fittings (ECGJH) or female union and male threaded end fitting (ECLK)

Specially formulated 40 mil PVC exterior coating with static-dissipative and flame-resistant properties

Specially formulated 2 mil urethane interior coating

Certification Descriptions



ISO 9001 CERTIFIED QUALITY MANAGEMENT SYSTEM FACILITY

Plasti-Bond has been certified an ISO 9001 Quality Management System Facility since 2009. Using effective, safe and efficient manufacturing methods and practices, Plasti-Bond ensures a universal level of quality that is reliable and consistent. Achieving ISO 9001 certification requires strong leadership, deep customer focus, fact-based decision making, continual improvement, mutually beneficial supplier relationships and a disciplined process and system approach.



UL LISTING MARK

UL 1203 – Safety Standard For Explosion-Proof and Dust-Ignition-Proof Electrical Equipment for Use in Hazardous (Classified) Locations

The UL Listing Mark is only applied to products that are manufactured in accordance with UL requirements and is verified by a UL field representative four times a year. Acquiring and maintaining this stringent verification is just one of the many ways that Plasti-Bond demonstrates its ongoing commitment to the highest possible standards for quality and safety.



ENHANCED AND SMART UL CERTIFICATION MARK AND BADGE SYSTEM

The Enhanced and Smart UL Certification Mark and Badge System delivers greater clarity in a product's compliance. QR codes featured on Plasti-Bond products can be scanned with common electronic devices to provide fast and convenient access to the UL Smart Marks hub, providing vital information about the product and certification compliance.

Conduit Unions



Description

Plasti-Bond REDH₂OT UNF unions are used to connect conduit to conduit or to allow for future changes to the conduit system. Female threads are provided at each end. Plasti-Bond REDH₂OT UNY unions are used to connect conduit to a conduit fitting, junction box or device enclosure. One end is a male thread and the other is female.

Features

- 40 mil gray PVC exterior coating
- 2 mil red urethane interior coating
- 13 trade sizes from 1/2" through 6"
- Sealing sleeves on all conduit openings
- Molded PVC gasket seals fitting

UNF

PIPE SIZE	FERROUS CATALOG #	NOMINAL WEIGHT	LENGTH	MAX DIA	ALUMINUM CATALOG #
1/2"	PRUNF105	0.3	1.81	2.00	PRUNF105SA
3/4"	PRUNF205	0.5	1.75	2.25	PRUNF205SA
3/4" – 1/2"	PRUNF215	0.6	1.75	2.25	-
1"	PRUNF305	0.7	2.00	2.75	PRUNF305SA
1-1/4"	PRUNF405	1.5	2.25	3.00	PRUNF405SA
1-1/2"	PRUNF505	2.3	2.63	3.50	PRUNF505SA
2"	PRUNF605	3.6	2.56	4.50	PRUNF605SA
2-1/2"	PRUNF705	5.0	3.19	4.75	PRUNF705SA
3"	PRUNF805	6.5	3.44	5.50	PRUNF805SA
3-1/2"	PRUNF905	8.2	4.13	6.50	PRUNF905SA
4"	PRUNF1005	10.0	4.13	7.00	PRUNF1005SA
5"	PRUNF012	12.5	3.81	9.00	-
6"	PRUNF014	14.8	3.81	10.25	-

Standards

UL 1203 (E476062)

- NEC/CEC
- CSA C22.2 NO.30

UNF/UNY 1/2" through 1"

- Class I, Division 1 & 2, Groups A, B, C, D
- Class II, Division 1, Groups E, F, G
- Class II, Division 2, Groups F, G
- Class III

UNF/UNY 905, 1005

- Class I, Division 1 & 2, Groups B, C, D
- Class II, Division 1, Groups E, F, G
- Class II, Division 2, Groups F, G
- Class III

UNF, UNY - all sizes

- Class I, Division 1 & 2, Groups C, D
- Class II, Division 1, Groups E, F, G
- Class II, Division 2, Groups F, G
- Class III

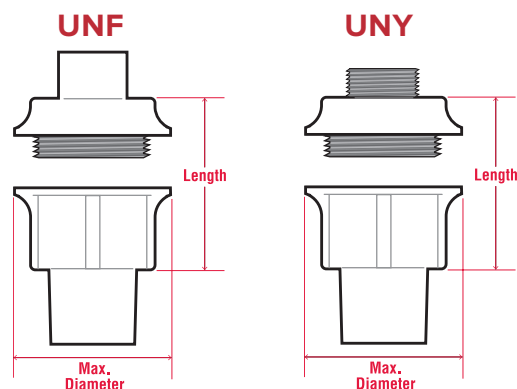

UNY

PIPE SIZE	FERROUS CATALOG #	NOMINAL WEIGHT	LENGTH	MAX DIA	ALUMINUM CATALOG #
1/2"	PRUNY105	0.4	2.38	2.00	PRUNY105SA
3/4"	PRUNY205	0.7	2.44	2.25	PRUNY205SA
3/4" – 1/2"	PRUNY215	0.8	2.44	2.25	-
1"	PRUNY305	1.3	2.75	2.75	PRUNY305SA
1-1/4"	PRUNY405	2.6	3.19	3.00	PRUNY405SA
1-1/2"	PRUNY505	3.9	3.56	3.50	PRUNY505SA
2"	PRUNY605	4.2	3.75	4.50	PRUNY605SA
2-1/2"	PRUNY705	5.5	4.63	4.75	PRUNY705SA
3"	PRUNY805	7.5	5.00	5.50	PRUNY805SA
3-1/2"	PRUNY905	8.4	5.50	6.50	PRUNY905SA
4"	PRUNY1005	10.5	5.63	7.00	PRUNY1005SA
5"	PRUNY012	12.0	5.25	9.00	-
6"	PRUNY014	14.9	5.38	10.25	-

Sealing Fittings

Description

Plasti-Bond REDH₂OT Sealing Fittings are used in conduit runs to stop gasses, vapors or flames from migrating from one part of the conduit system to another. This limits the spread of any potential explosion, enhancing safety. The PVC and urethane coatings of the fittings protect them from corrosive atmospheres so they can continue to function in hazardous locations. These fittings are available in several different configurations with optional breathers and drains to accommodate installation in a variety of locations and positions. The EYD, EYDX and EZD styles of fittings are for installation in vertical conduit runs. The EYS and EYSX style fittings are for installation in either vertical or horizontal runs. The EZS style fitting may be used in any angle of conduit run.



* Patent Pending

Features

- 40 mil gray PVC exterior coating
- 2 mil red urethane interior coating
- 10 trade sizes from ½" through 4"
- Sealing sleeves on all conduit openings
- EYDX and EYSX seals have 40% wire fill capacity
- EYD and EZD fittings include a drain for condensate
- EZD fittings may be used at any conduit angle and include drain
- P5SA™ Plug Verification System

Standards

UL 1203 (E476062)

- NEC/CEC
- CSA C22.2 NO.30

EYS 1-3, 11-31, 16-36, 116-316

- Class I, Division 1 & 2, Groups A, B, C, D
- Class II, Division 1, Groups E, F, G
- Class II, Division 2, Groups F, G
- Class III

EYS 41-61, 416-1016, EYSX 11-81, EYDX 11-81

- Class I, Division 1 & 2, Groups B, C, D
- Class II, Division 1, Groups E, F, G
- Class II, Division 2, Groups F, G
- Class III

EYS 29, 4-10, 46-106, EZS 1-8, 16-86, EYD 1-10, 16-106, EZD 10-60, 111-611

- Class I, Division 1 & 2, Groups C, D
- Class II, Division 1, Groups F, G
- Class II, Division 2, Groups F, G
- Class III

EYSX 9-10

- Class I, Division 1 & 2, Groups C, D
- Class II, Division 1, Groups E, F, G
- Class II, Division 2, Groups F, G
- Class III

These Plasti-Bond REDH₂OT sealing fittings should be used with a suitable system of sealing compound, such as Chico A, Chico X or Chico A-P from Crouse-Hinds. Chico® SpeedSeal™ may be used on EYS or EYD sizes ½" - 2". Follow the installation instructions included with the sealing compound and properly tag after installation to ensure correct classification ratings.

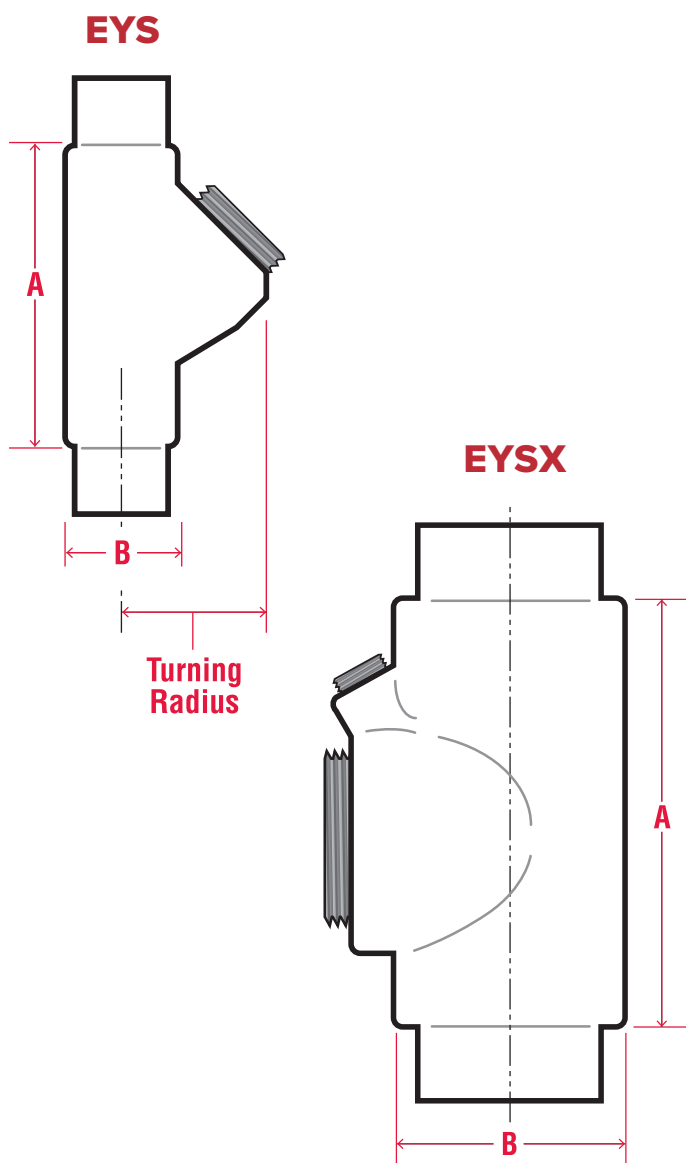

EYS - Female Hubs For Sealing in Vertical Positions Only

PIPE SIZE	FERROUS CATALOG #	NOMINAL WEIGHT	A	B	TURNING RADIUS	ALUMINUM CATALOG #
1/2"	PREYS1	1.0	3.28	1.33	1.63	PREYS1SA
3/4"	PREYS2	1.5	3.75	1.58	1.91	PREYS2SA
1"	PREYS3	2.1	4.31	1.83	2.38	PREYS3SA

For Sealing in Vertical or Horizontal Positions

1-1/4"	PREYS4	2.7	5.06	2.27	1.72	PREYS4SA
1-1/2"	PREYS5	3.7	5.50	2.52	2.06	PREYS5SA
2"	PREYS6	4.7	6.25	3.08	2.31	PREYS6SA
2-1/2"	PREYS7	10.0	7.50	3.58	2.69	PREYS7SA
3"	PREYS8	11.2	8.50	4.33	3.31	PREYS8SA
3-1/2"	PREYS9	14.5	9.19	4.83	3.44	PREYS9SA
4"	PREYS10	16.0	9.75	5.33	3.69	PREYS10SA

EYS - Male/Female Hubs For Sealing in Vertical Positions Only

PIPE SIZE	FERROUS CATALOG #	NOMINAL WEIGHT	A	B	TURNING RADIUS	ALUMINUM CATALOG #
1/2"	PREYS16	1.5	3.28	1.33	1.63	PREYS16SA
3/4"	PREYS26	1.5	3.75	1.58	1.91	PREYS26SA
1"	PREYS36	2.3	4.31	1.83	2.38	PREYS36SA

EYS - Female Hubs For Sealing in Vertical or Horizontal Positions

PIPE SIZE	FERROUS CATALOG #	NOMINAL WEIGHT	A	B	TURNING RADIUS	ALUMINUM CATALOG #
1/2"	PREYS11	1.3	3.69	1.33	1.16	PREYS11SA
3/4"	PREYS21	1.1	3.69	1.58	1.25	PREYS21SA
1"	PREYS31	2.2	4.31	1.83	1.38	PREYS31SA
1-1/4"	PREYS41	3.0	5.06	2.27	1.72	-
1-1/2"	PREYS51	3.8	5.50	2.52	2.06	-
2"	PREYS61	5.5	6.25	3.08	2.31	-

EYS - Male/Female Hubs For Sealing in Vertical or Horizontal Positions

PIPE SIZE	FERROUS CATALOG #	NOMINAL WEIGHT	A	B	TURNING RADIUS	ALUMINUM CATALOG #
1/2"	PREYS116	1.5	3.69	1.33	1.16	PREYS116SA
3/4"	PREYS216	1.2	3.69	1.58	1.25	PREYS216SA
1"	PREYS316	2.6	4.31	1.83	1.38	PREYS316SA
1-1/4"	PREYS46	2.8	5.06	2.27	1.72	PREYS46SA
1-1/2"	PREYS56	3.7	5.50	2.52	2.06	PREYS56SA
2"	PREYS66	5.6	6.25	3.08	2.31	PREYS66SA
2-1/2"	PREYS76	13.2	7.50	3.58	2.69	PREYS76SA
3"	PREYS86	11.2	8.50	4.33	3.31	PREYS86SA
3-1/2"	PREYS96	14.5	9.19	4.83	3.44	PREYS96SA
4"	PREYS106	1.5	9.75	5.33	3.69	PREYS106SA

EYSX - Expanded Fill Female Hubs For Sealing in Vertical or Horizontal Positions

PIPE SIZE	FERROUS CATALOG #	NOMINAL WEIGHT	A	B	TURNING RADIUS	ALUMINUM CATALOG #
1/2"	PREYSX11	1.5	3.69	1.58	1.25	PREYSX1SA
3/4"	PREYSX21	2.1	4.31	1.83	1.38	PREYSX2SA
1"	PREYSX31	2.7	5.06	2.27	1.72	PREYSX3SA
1-1/4"	PREYSX41	3.7	6.25	3.08	2.31	PREYSX4SA
1-1/2"	PREYSX51	4.7	6.25	3.08	2.31	PREYSX5SA
2"	PREYSX61	6.7	8.50	4.33	3.31	PREYSX6SA
2-1/2"	PREYSX71	7.7	9.19	4.83	3.44	PREYSX7SA
3"	PREYSX81	8.7	9.75	5.33	3.69	PREYSX8SA
3-1/2"	PREYSX9	9.7	11.06	6.58	4.59	PREYSX9SA
4"	PREYSX10	10.7	11.06	6.58	4.59	PREYSX10SA

Sealing Fittings

EYD 1/2" - 1"

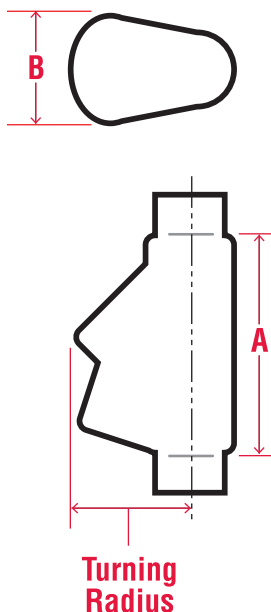

EYD 1-1/4" - 4"

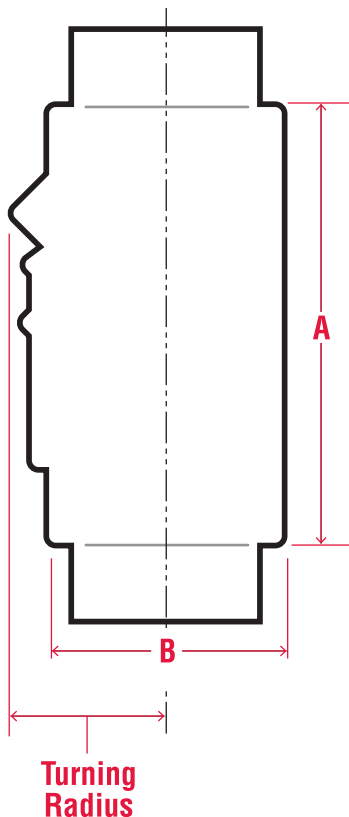

EYD - Female Hubs With Drain For Sealing in Vertical Positions Only

PIPE SIZE	FERROUS CATALOG #	NOMINAL WEIGHT	A	B	TURNING RADIUS	ALUMINUM CATALOG #
1/2"	PREYD1	1.4	3.28	1.33	1.63	PREYD1SA
3/4"	PREYD2	1.7	3.69	1.58	1.91	PREYD2SA
1"	PREYD3	2.3	4.31	2.27	2.38	PREYD3SA
1-1/4"	PREYD4	2.5	5.06	2.27	1.84	PREYD4SA
1-1/2"	PREYD5	4.0	5.50	2.52	2.06	PREYD5SA
2"	PREYD6	4.7	6.25	3.08	2.31	PREYD6SA
2-1/2"	PREYD7	9.0	7.50	3.58	2.69	PREYD7SA
3"	PREYD8	10.2	8.50	4.33	3.31	PREYD8SA
3-1/2"	PREYD9	10.5	9.19	4.83	3.44	PREYD9SA
4"	PREYD10	4.0	9.75	5.33	3.50	PREYD10SA

EYD - Male/Female Hubs With Drain For Sealing in Vertical Positions Only

PIPE SIZE	FERROUS CATALOG #	NOMINAL WEIGHT	A	B	TURNING RADIUS	ALUMINUM CATALOG #
1/2"	PREYD16	2.7	3.28	1.33	1.63	PREYD16SA
3/4"	PREYD26	2.8	3.69	1.58	1.91	PREYD26SA
1"	PREYD36	2.9	4.31	2.27	2.38	PREYD36SA
1-1/4"	PREYD46	2.6	5.06	2.27	1.84	PREYD46SA
1-1/2"	PREYD56	3.7	5.50	2.52	2.06	PREYD56SA
2"	PREYD66	5.2	6.25	3.08	2.31	PREYD66SA
2-1/2"	PREYD76	9.5	7.50	3.58	2.69	PREYD76SA
3"	PREYD86	11.3	8.50	4.33	3.31	PREYD86SA
3-1/2"	PREYD96	12.5	9.19	4.83	3.44	PREYD96SA
4"	PREYD106	16.7	9.75	5.33	3.50	PREYD106SA

EYDX - Expanded Fill Female Hubs With Drain For Sealing in Vertical Positions Only

PIPE SIZE	FERROUS CATALOG #	NOMINAL WEIGHT	A	B	TURNING RADIUS	ALUMINUM CATALOG #
1/2"	PREYDX11	1.7	3.69	1.83	1.91	PREYDX1SA
3/4"	PREYDX21	2.3	4.31	2.27	2.38	PREYDX2SA
1"	PREYDX31	2.5	5.06	2.27	1.84	PREYDX3SA
1-1/4"	PREYDX41	4.0	6.25	3.08	2.31	PREYDX4SA
1-1/2"	PREYDX51	4.7	6.25	3.08	2.31	PREYDX5SA
2"	PREYDX61	9.0	8.50	4.33	3.31	PREYDX6SA
2-1/2"	PREYDX71	10.2	9.19	4.83	3.44	PREYDX7SA
3"	PREYDX81	10.5	9.75	5.33	3.50	PREYDX8SA

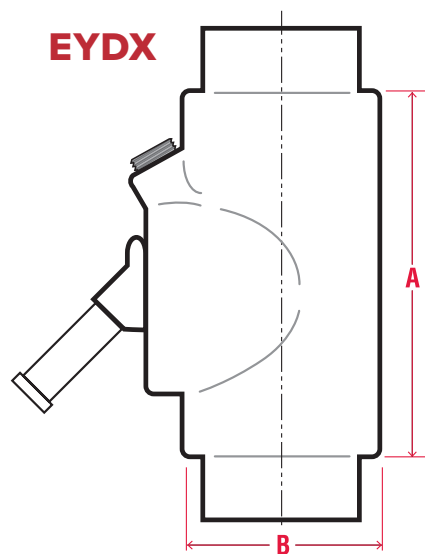

EZS

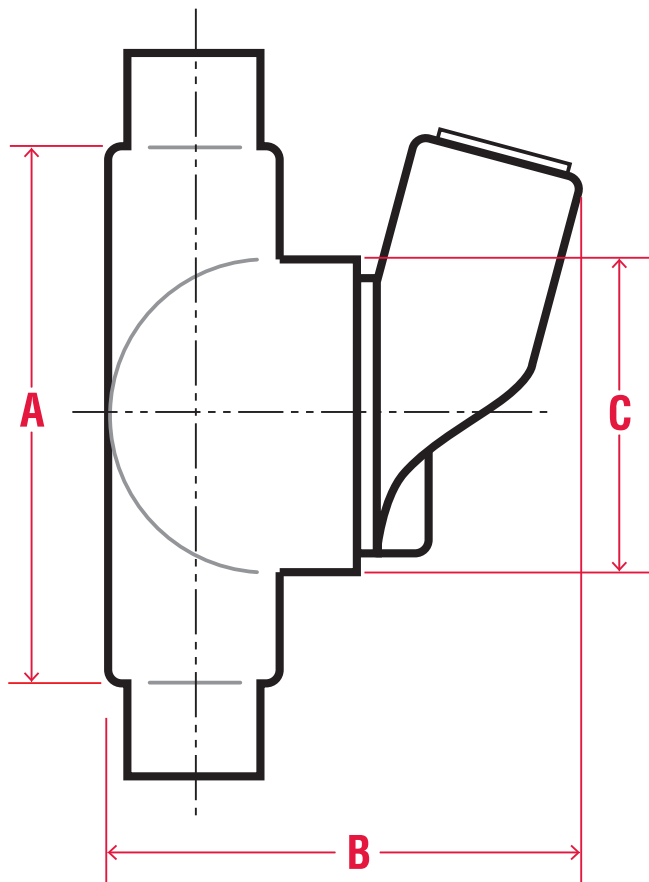

EZS - Female Hubs For Sealing in Any Position

PIPE SIZE	FERROUS CATALOG #	NOMINAL WEIGHT	A	B	C	TURNING RADIUS
1/2"	PREZS1	2.0	4.19	3.71	2.58	1.88
3/4"	PREZS2	2.3	4.19	3.71	2.58	1.88
1"	PREZS3	2.7	4.94	4.05	3.08	2.13
1-1/4"	PREZS4	3.5	5.06	4.49	3.08	2.31
1-1/2"	PREZS5	4.0	5.19	4.64	3.33	2.34
2"	PREZS6	8.2	7.06	5.49	5.27	3.28
2-1/2"	PREZS7	8.5	7.94	5.92	5.27	3.38
3"	PREZS8	9.0	8.63	6.58	5.96	3.88

EZS - Male/Female Hubs With Drain For Sealing in Any Position

PIPE SIZE	FERROUS CATALOG #	NOMINAL WEIGHT	A	B	C	TURNING RADIUS
1/2"	PREZS16	2.0	4.19	3.71	2.58	1.88
3/4"	PREZS26	2.4	4.19	3.71	2.58	1.88
1"	PREZS36	3.0	4.94	4.05	3.08	2.13
1-1/4"	PREZS46	4.0	5.06	4.49	3.08	2.31
1-1/2"	PREZS56	4.6	5.19	4.64	3.33	2.34
2"	PREZS66	6.9	7.06	5.49	5.27	3.28
2-1/2"	PREZS76	9.2	7.94	5.92	5.27	3.38
3"	PREZS86	8.7	8.63	6.58	5.96	3.88

EZD - Female Hubs With Drain and Inspection Cover

PIPE SIZE	FERROUS CATALOG #	A	B	C	TURNING RADIUS
1/2"	PREZD111	4.19	3.08	3.46	2.06
3/4"	PREZD211	4.19	3.08	3.71	2.19
1"	PREZD311	4.94	3.58	3.96	2.44
1-1/4"	PREZD411	4.94	3.58	4.39	2.63
1-1/2"	PREZD511	5.19	3.58	4.64	2.69
2"	PREZD611	7.13	5.64	5.33	3.69

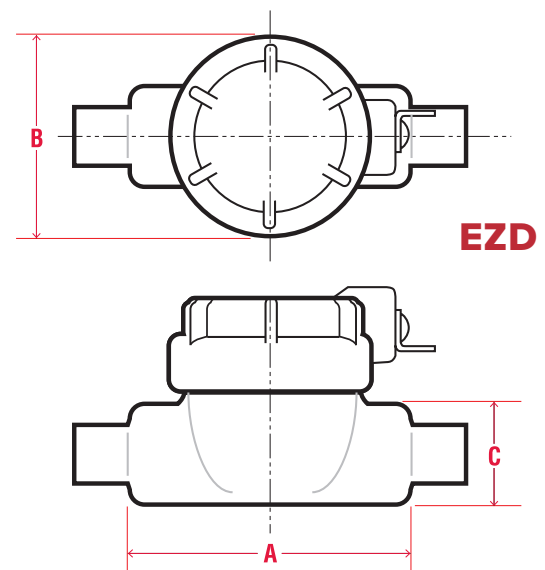

GUA Series Outlet Boxes

Description

Plasti-Bond REDH₂OT GUA series conduit outlet boxes are installed in hazardous location conduit systems to serve as pull-and-splice boxes, to change the direction of a conduit run, to connect runs of conduit or to provide access to conductors. They are provided with covers as standard. Inquire about special covers to allow use to mount lighting fixtures or as sealing fittings. Electrical continuity of the conduit system is maintained across assembled joints.

Features

- 40 mil gray PVC exterior coating
- 2 mil red urethane interior coating
- Trade sizes from ½" - 2" in various styles and configurations
- Sealing sleeves on all conduit openings
- Neoprene O-ring is standard
- Molded-in PVC seal preserves venting characteristics of fitting and seals out corrosives
- Standard material is a cast iron alloy body with a copper-free aluminum cover. Consult Factory for availability of cast iron covers
- Internal green grounding screw is standard

Standards

UL 1203 (E495357)

- NEC/CEC
- CSA C22.2 NO.30

Steel and Aluminum

- UL 514A, 514D (E231035)
- CSA C22.2 No. 18, CSA C22.2 No. 42

NEC/CEC

- Class I, Division 1 & 2, Groups C, D
- Class II, Division 1, Groups E, F, G
- Class II, Division 2, Groups F, G
- Class III

ANSI Standard C-33.27

NEMA/EEMAC 3,4

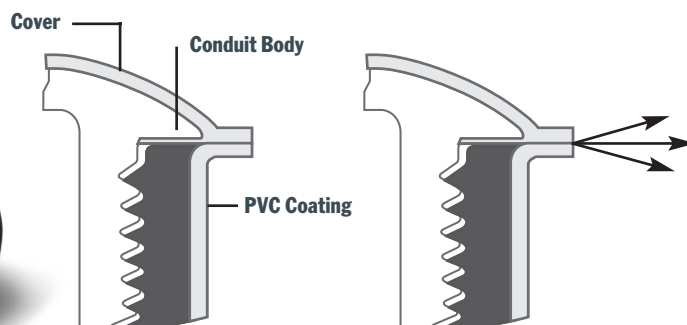

An integral PVC gasket on GUA type fittings preserves the venting characteristics of the uncoated fitting and prevents corrosive liquids from entering from the outside.

Variables referenced to the technical data charts.

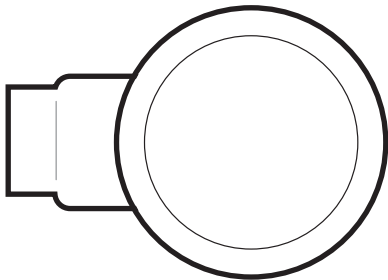
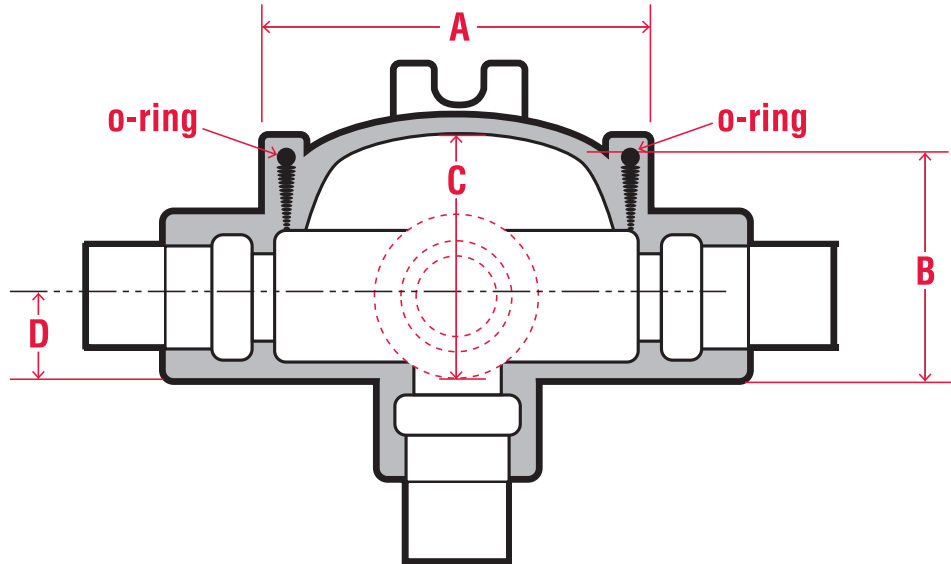

GUA

PIPE SIZE	FERROUS CATALOG #	COVER OPENING	ALUMINUM CATALOG #	PRODUCT DIMENSIONS			
				A	B	C	D
1/2"	PRGUA14	2"	-	2.58	1.85	1.75	0.67
1/2"	PRGUA16	3"	-	3.58	2.04	1.88	0.67
3/4"	PRGUA24	2"	-	2.58	2.04	2.00	0.79
3/4"	PRGUA26	3"	PRGUA26SA	3.58	2.04	1.88	0.79
1"	PRGUA36	3"	-	3.58	2.35	2.19	0.92
1-1/4"	PRGUA47	3-5/8"	-	4.33	2.73	2.75	1.13
1-1/2"	PRGUA59	5"	-	5.83	3.85	3.75	1.32

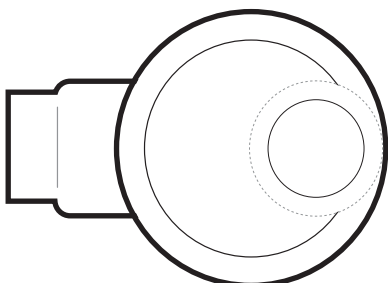

GUAB

PIPE SIZE	FERROUS CATALOG #	COVER OPENING	NOMINAL WEIGHT	ALUMINUM CATALOG #	PRODUCT DIMENSIONS			
					A	B	C	D
1/2"	PRGUAB14	2"	2.0	PRGUAB14SA	2.58	2.29	2.19	0.67
1/2"	PRGUAB16	3"	3.2	PRGUAB16SA	3.58	2.04	1.88	0.67
3/4"	PRGUAB24	2"	2.2	-	2.58	2.54	2.44	0.79
3/4"	PRGUAB26	3"	3.3	PRGUAB26SA	3.58	2.04	1.88	0.79
1"	PRGUAB36	3"	3.8	PRGUAB36SA	3.58	2.35	2.19	0.92
1-1/4"	PRGUAB47	3-5/8"	5.0	PRGUAB47SA	4.33	2.73	2.75	1.13
1-1/2"	PRGUAB59	5"	8.1	PRGUAB59SA	5.83	3.85	3.75	1.32
2"	PRGUAB69	5"	9.1	PRGUAB69SA	5.83	4.10	4.00	1.60

GUA Series Outlet Boxes

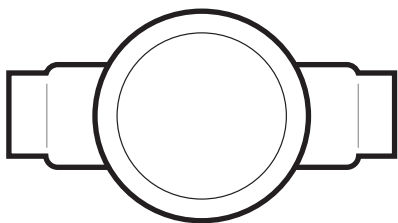

GUAC

PIPE SIZE	FERROUS CATALOG #	COVER OPENING	NOMINAL WEIGHT	ALUMINUM CATALOG #	PRODUCT DIMENSIONS			
					A	B	C	D
1/2"	PRGUAC14	2"	3.5	PRGUAC14SA	2.58	2.29	2.19	0.67
1/2"	PRGUAC16	3"	2.0	PRGUAC16SA	3.58	2.04	1.88	0.67
3/4"	PRGUAC24	2"	3.5	PRGUAC24SA	2.58	2.04	2.00	0.79
3/4"	PRGUAC26	3"	2.0	PRGUAC26SA	3.58	2.04	1.88	0.79
1"	PRGUAC36	3"	3.9	PRGUAC36SA	3.58	2.35	2.19	0.92
1-1/4"	PRGUAC47	3-5/8"	5.2	PRGUAC47SA	4.33	2.73	2.75	1.13
1-1/4"	PRGUAC49	5"	9.5	-	5.83	3.85	3.75	1.20
1-1/2"	PRGUAC59	5"	11.0	PRGUAC59SA	5.83	3.85	3.75	1.32
2"	PRGUAC69	5"	11.0	PRGUAC69SA	5.83	4.10	4.00	1.60

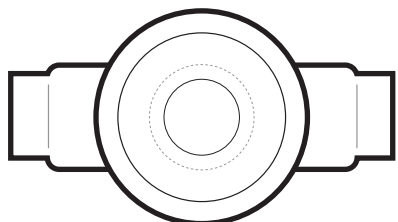

GUAD

PIPE SIZE	FERROUS CATALOG #	COVER OPENING	NOMINAL WEIGHT	ALUMINUM CATALOG #	PRODUCT DIMENSIONS			
					A	B	C	D
1/2"	PRGUAD14	2"	2.0	-	2.58	1.85	1.75	0.67
1/2"	PRGUAD16	3"	3.2	-	3.58	2.04	1.88	0.67
3/4"	PRGUAD24	2"	3.5	-	2.58	2.04	2.00	0.79
3/4"	PRGUAD26	3"	3.8	PRGUAD26SA	3.58	2.04	1.88	0.79
1"	PRGUAD36	3"	3.8	PRGUAD36SA	3.58	2.35	2.19	0.92
1-1/4"	PRGUAD49	5"	10.9	-	5.83	3.85	3.75	1.13

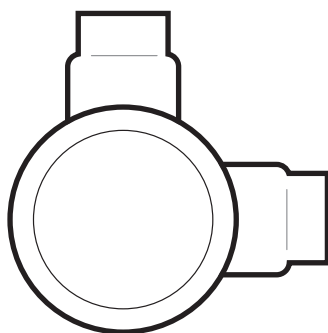

GUAL

PIPE SIZE	FERROUS CATALOG #	COVER OPENING	NOMINAL WEIGHT	ALUMINUM CATALOG #	PRODUCT DIMENSIONS			
					A	B	C	D
1/2"	PRGUAL14	2"	2.0	PRGUAL14SA	2.58	1.85	1.75	0.67
1/2"	PRGUAL16	3"	2.1	PRGUAL16SA	3.58	2.04	1.88	0.67
3/4"	PRGUAL24	2"	3.2	PRGUAL24SA	2.58	2.04	2.00	0.79
3/4"	PRGUAL26	3"	2.5	PRGUAL26SA	3.58	2.04	1.88	0.79
1"	PRGUAL36	3"	3.7	PRGUAL36SA	3.58	2.35	2.19	0.92
1-1/4"	PRGUAL47	3-5/8"	5.2	PRGUAL47SA	4.33	2.73	2.75	1.13
1-1/4"	PRGUAL49	5"	8.5	PRGUAL49SA	5.83	3.85	3.75	1.20
1-1/2"	PRGUAL59	5"	11.2	PRGUAL59SA	5.83	3.85	3.75	1.32
2"	PRGUAL69	5"	12.5	PRGUAL69SA	5.83	4.10	4.00	1.60

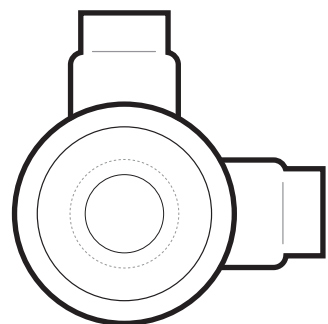

GUAM

PIPE SIZE	FERROUS CATALOG #	COVER OPENING	NOMINAL WEIGHT	ALUMINUM CATALOG #	PRODUCT DIMENSIONS			
					A	B	C	D
1/2"	PRGUAM14	2"	2.0	PRGUAM14SA	2.58	1.85	1.75	0.67
1/2"	PRGUAM16	3"	3.2	-	3.58	2.04	1.88	0.67
3/4"	PRGUAM24	2"	2.2	-	2.58	2.04	2.00	0.79
3/4"	PRGUAM26	3"	3.3	-	3.58	2.04	1.88	0.79
1"	PRGUAM36	3"	3.8	-	3.58	2.35	2.19	0.92
1-1/4"	PRGUAM47	3-5/8"	5.0	-	4.33	2.73	2.75	1.13
2"	PRGUAM69	5"	9.1	-	5.83	4.10	4.00	1.60

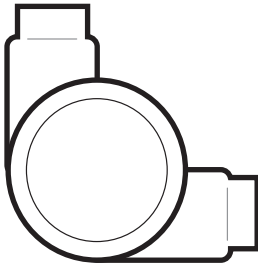

GUAN

PIPE SIZE	FERROUS CATALOG #	COVER OPENING	NOMINAL WEIGHT	PRODUCT DIMENSIONS			
				A	B	C	D
1/2"	PRGUAN14	2"	2.0	2.58	2.17	2.06	0.67
1/2"	PRGUAN16	3"	3.8	3.58	2.04	1.88	0.67
3/4"	PRGUAN24	2"	2.5	2.58	2.35	2.25	0.79
3/4"	PRGUAN26	3"	3.5	3.58	2.04	1.88	0.79
1"	PRGUAN36	3"	3.0	3.58	2.35	2.38	0.92
1-1/4"	PRGUAN47	3-5/8"	5.2	4.33	2.73	2.75	1.13
1-1/2"	PRGUAN59	5"	9.5	5.83	4.10	4.00	1.32
2"	PRGUAN69	5"	12.0	5.83	4.10	4.00	1.60

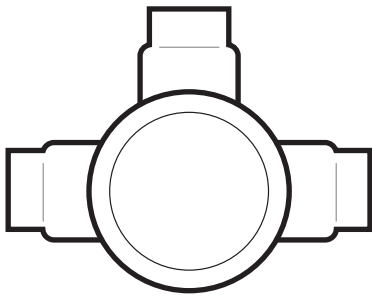

GUAT

PIPE SIZE	FERROUS CATALOG #	COVER OPENING	NOMINAL WEIGHT	ALUMINUM CATALOG #	PRODUCT DIMENSIONS			
					A	B	C	D
1/2"	PRGUAT14	2"	2.0	PRGUAT14SA	2.58	2.29	2.19	0.67
1/2"	PRGUAT16	3"	2.8	PRGUAT16SA	3.58	2.04	1.88	0.67
3/4"	PRGUAT24	2"	2.2	PRGUAT24SA	2.58	2.04	2.00	0.79
3/4"	PRGUAT26	3"	3.5	PRGUAT26SA	3.58	2.04	1.88	0.79
1"	PRGUAT36	3"	3.2	PRGUAT36SA	3.58	2.35	2.19	0.92
1-1/4"	PRGUAT47	3-5/8"	5.7	PRGUAT47SA	4.33	2.73	2.75	1.13
1-1/2"	PRGUAT59	5"	9.1	PRGUAT59SA	5.83	3.85	3.75	1.32
2"	PRGUAT69	5"	10.0	PRGUAT69SA	5.83	4.10	4.00	1.60

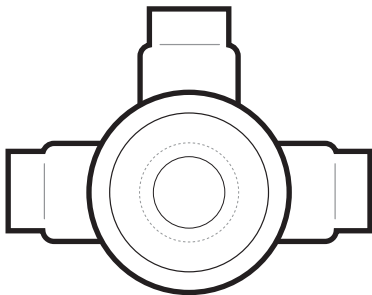

GUAW

PIPE SIZE	FERROUS CATALOG #	COVER OPENING	NOMINAL WEIGHT	ALUMINUM CATALOG #	PRODUCT DIMENSIONS			
					A	B	C	D
1/2"	PRGUAW14	2"	2.0	-	2.58	1.85	1.75	0.67
1/2"	PRGUAW16	3"	2.0	-	3.58	2.04	1.88	0.67
3/4"	PRGUAW24	2"	3.0	-	2.58	2.04	2.00	0.79
3/4"	PRGUAW26	3"	3.0	PRGUAW26SA	3.58	2.04	1.88	0.79

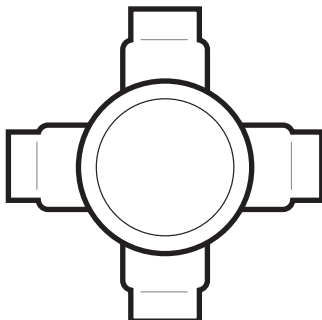

GUAX

PIPE SIZE	FERROUS CATALOG #	COVER OPENING	NOMINAL WEIGHT	ALUMINUM CATALOG #	PRODUCT DIMENSIONS			
					A	B	C	D
1/2"	PRGUAX14	2"	2.0	-	2.58	1.85	1.75	0.67
1/2"	PRGUAX16	3"	3.8	PRGUAX16SA	3.58	2.04	1.88	0.67
3/4"	PRGUAX24	2"	2.5	PRGUAX24SA	2.58	2.04	2.00	0.79
3/4"	PRGUAX26	3"	2.8	PRGUAX26SA	3.58	2.04	1.88	0.79
1"	PRGUAX36	3"	4.2	PRGUAX36SA	3.58	2.35	2.19	0.92
1-1/4"	PRGUAX47	3-5/8"	4.8	PRGUAX47SA	4.33	2.73	2.75	1.13
1-1/2"	PRGUAX59	5"	11.7	PRGUAX59SA	5.83	3.85	3.75	1.32
2"	PRGUAX69	5"	12.5	PRGUAX69SA	5.83	4.10	4.00	1.60

ECGJH and ECLK Series Couplings



Description

EC Series Couplings are used in hazardous areas where a flexible member is required in a conduit system to accomplish difficult bends or to allow for movement or vibration of connected equipment or units.

Features

- 40 mil gray PVC exterior coating
- Rugged design to withstand explosive pressure (Class I) and mechanical abuse
- Liquid Tight for wet locations
- For use where lack of space makes use of rigid conduit difficult
- Wire duct liner in sizes 1/2" to 2" insulates against grounds and burn-through from short circuit
- No bonding jumpers required; metallic braid provides continuous electrical path
- ECGJH combination has two threaded male end fittings
- ECLK combination has one female union and one male threaded end fitting

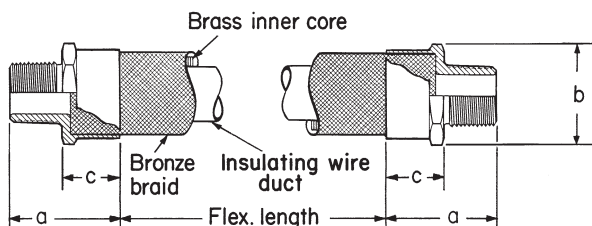

Dimensions (In Inches)

HUB SIZE	A	B	C	D	E
1/2"	1-7/8	1-1/2	1-1/8	3	1-9/16
3/4"	2-1/16	1-7/8	1-3/16	3-1/4	1-13/16
1"	2-1/2	2-1/8	1-1/2	3-5/8	1-7/8
1-1/4"	2-7/8	2-15/16	1-7/8	4-3/16	2-3/4
1-1/2"	3-5/16	3-1/2	1-7/8	5-3/16	3-1/16
2"	3-1/4	4-1/4	2	5-1/16	3-13/16
2-1/2"	3	4-7/16	1-5/8	5-1/16	4-5/16
3"	3-1/8	4-9/16	1-3/4	5-3/8	5-1/16
4"	4-5/8	4-15/16	3-1/4	7-1/2	6-3/16

Standards

NEC/CEC

- 1/2" and 3/4": Class I, Division 1, Groups A, B, C, D
- 1" to 2": Class I, Division 1, Groups C, D
- All sizes for use in Class II, Division 1, Groups E, F, G; Class III

UL Standard

- UL 1203
- CSA C22.2 NO.30

Standard Materials and Fittings

- End fittings – 1/2" to 2": forged brass, natural; 2 1/2" to 4": stainless steel, natural
- Female unions – 1/2" to 1": steel, electrogalvanized with PVC coating; 1 1/4" to 4": Feraloy® iron alloy, electrogalvanized with PVC coating
- 1/2" to 2" have bronze braid covering and flexible brass inner core; packing is woven cotton braid impregnated with asphalt
- 2 1/2" to 4" have a Type 304 stainless steel braid

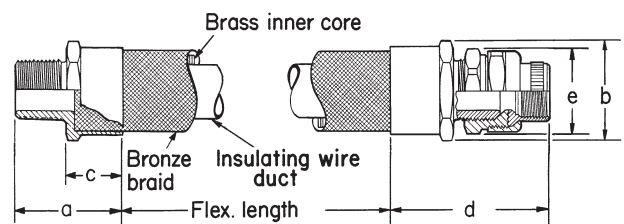

Minimum Recommended Radius of Bend

HUB SIZE	RADIUS
1/2"	10
3/4"	12
1"	14
1-1/4"	14
1-1/2"	16
2"	16
2-1/2"	16
3"	18
4"	30

ECGJH Ordering Information

FLEXIBLE LENGTH	HUB SIZE	CATALOG #	FLEXIBLE LENGTH	HUB SIZE	CATALOG #	FLEXIBLE LENGTH	HUB SIZE	CATALOG #	FLEXIBLE LENGTH	HUB SIZE	CATALOG #
4	1/2	PBECGJH14	15	1-1/4	PBECGJH415	21	4	PBECGJH1021	30	1-1/2	PBECGJH530
4	3/4	PBECGJH24	15	1-1/2	PBECGJH515	24	1/2	PBECGJH124	30	2	PBECGJH630
6	1/2	PBECGJH16	15	2	PBECGJH615	24	3/4	PBECGJH224	30	2-1/2	PBECGJH730
6	3/4	PBECGJH26	15	2-1/2	PBECGJH715	24	1	PBECGJH324	30	3	PBECGJH830
6	1	PBECGJH36	15	3	PBECGJH815	24	1-1/4	PBECGJH424	30	4	PBECGJH1030
8	1/2	PBECGJH18	15	4	PBECGJH1015	24	1-1/2	PBECGJH524	33	1/2	PBECGJH133
8	3/4	PBECGJH28	18	1/2	PBECGJH118	24	2	PBECGJH624	33	3/4	PBECGJH233
8	1	PBECGJH38	18	3/4	PBECGJH218	24	2-1/2	PBECGJH724	33	1	PBECGJH333
10	1/2	PBECGJH110	18	1	PBECGJH318	24	3	PBECGJH824	33	1-1/4	PBECGJH433
10	3/4	PBECGJH210	18	1-1/4	PBECGJH418	24	4	PBECGJH1024	33	1-1/2	PBECGJH533
10	1	PBECGJH310	18	1-1/2	PBECGJH518	27	1/2	PBECGJH127	33	2	PBECGJH633
12	1/2	PBECGJH112	18	2	PBECGJH618	27	3/4	PBECGJH227	33	2-1/2	PBECGJH733
12	3/4	PBECGJH212	18	2-1/2	PBECGJH718	27	1	PBECGJH327	33	3	PBECGJH833
12	1	PBECGJH312	18	3	PBECGJH818	27	1-1/4	PBECGJH427	33	4	PBECGJH1033
12	1-1/4	PBECGJH412	18	4	PBECGJH1018	27	1-1/2	PBECGJH527	36	1/2	PBECGJH136
12	1-1/2	PBECGJH512	21	1/2	PBECGJH121	27	2	PBECGJH627	36	3/4	PBECGJH236
12	2	PBECGJH612	21	3/4	PBECGJH221	27	2-1/2	PBECGJH727	36	1	PBECGJH336
12	2-1/2	PBECGJH712	21	1	PBECGJH321	27	3	PBECGJH827	36	1-1/4	PBECGJH436
12	3	PBECGJH812	21	1-1/4	PBECGJH421	27	4	PBECGJH1027	36	1-1/2	PBECGJH536
12	4	PBECGJH1012	21	1-1/2	PBECGJH521	30	1/2	PBECGJH130	36	2	PBECGJH636
15	1/2	PBECGJH115	21	2	PBECGJH621	30	3/4	PBECGJH230	36	2-1/2	PBECGJH736
15	3/4	PBECGJH215	21	2-1/2	PBECGJH721	30	1	PBECGJH330	36	3	PBECGJH836
15	1	PBECGJH315	21	3	PBECGJH821	30	1-1/4	PBECGJH430	36	4	PBECGJH1036

ECLK Ordering Information

FLEXIBLE LENGTH	HUB SIZE	CATALOG #	FLEXIBLE LENGTH	HUB SIZE	CATALOG #	FLEXIBLE LENGTH	HUB SIZE	CATALOG #	FLEXIBLE LENGTH	HUB SIZE	CATALOG #
4	1/2	PBECLK14	15	1-1/4	PBECLK415	21	4	PBECLK1021	30	1-1/2	PBECLK530
4	3/4	PBECLK24	15	1-1/2	PBECLK515	24	1/2	PBECLK124	30	2	PBECLK630
6	1/2	PBECLK16	15	2	PBECLK615	24	3/4	PBECLK224	30	2-1/2	PBECLK730
6	3/4	PBECLK26	15	2-1/2	PBECLK715	24	1	PBECLK324	30	3	PBECLK830
6	1	PBECLK36	15	3	PBECLK815	24	1-1/4	PBECLK424	30	4	PBECLK1030
8	1/2	PBECLK18	15	4	PBECLK1015	24	1-1/2	PBECLK524	33	1/2	PBECLK133
8	3/4	PBECLK28	18	1/2	PBECLK118	24	2	PBECLK624	33	3/4	PBECLK233
8	1	PBECLK38	18	3/4	PBECLK218	24	2-1/2	PBECLK724	33	1	PBECLK333
10	1/2	PBECLK110	18	1	PBECLK318	24	3	PBECLK824	33	1-1/4	PBECLK433
10	3/4	PBECLK210	18	1-1/4	PBECLK418	24	4	PBECLK1024	33	1-1/2	PBECLK533
10	1	PBECLK310	18	1-1/2	PBECLK518	27	1/2	PBECLK127	33	2	PBECLK633
12	1/2	PBECLK112	18	2	PBECLK618	27	3/4	PBECLK227	33	2-1/2	PBECLK733
12	3/4	PBECLK212	18	2-1/2	PBECLK718	27	1	PBECLK327	33	3	PBECLK833
12	1	PBECLK312	18	3	PBECLK818	27	1-1/4	PBECLK427	33	4	PBECLK1033
12	1-1/4	PBECLK412	18	4	PBECLK1018	27	1-1/2	PBECLK527	36	1/2	PBECLK136
12	1-1/2	PBECLK512	21	1/2	PBECLK121	27	2	PBECLK627	36	3/4	PBECLK236
12	2	PBECLK612	21	3/4	PBECLK221	27	2-1/2	PBECLK727	36	1	PBECLK336
12	2-1/2	PBECLK712	21	1	PBECLK321	27	3	PBECLK827	36	1-1/4	PBECLK436
12	3	PBECLK812	21	1-1/4	PBECLK421	27	4	PBECLK1027	36	1-1/2	PBECLK536
12	4	PBECLK1012	21	1-1/2	PBECLK521	30	1/2	PBECLK130	36	2	PBECLK636
15	1/2	PBECLK115	21	2	PBECLK621	30	3/4	PBECLK230	36	2-1/2	PBECLK736
15	3/4	PBECLK215	21	2-1/2	PBECLK721	30	1	PBECLK330	36	3	PBECLK836
15	1	PBECLK315	21	3	PBECLK821	30	1-1/4	PBECLK430	36	4	PBECLK1036

Installation



Sealing Fittings

To minimize the passage of gases and vapors and to prevent the passage of flames through the conduit from one portion of the electrical installation to another, seals must be installed to specification as required by the National Electrical Code® (NEC) in Article 501, Section 501-5 and 502-5.

Though not required by Code, sectionalizing long conduit runs is considered good practice. Depending on the conduit size, the insertion of seals not more than 50 to 100 feet apart is recommended to minimize the effects of “pressure piling.”

Plasti-Bond sealing fittings can be used to meet both of these requirements.

Types of Sealing Fittings

EYD DRAIN SEALING FITTINGS – Used with vertical conduit runs

- Prevents accumulation of water above seals in conduit systems
- Guards against insulation failure and other defects caused by the presence of water in the conduit system

EZS SEALING FITTINGS – Used with vertical, horizontal or any angle conduit runs

EZS DRAIN SEALING FITTINGS (1/2" to 2")

- Covers can be removed readily, permitting inspection during installation or at any time thereafter
- Provides continuous draining to prevent water accumulation

EZD INSPECTION SEALING FITTINGS (1/2" to 2")

- Covers can be removed readily, permitting inspection during installation or at any time
- Inspection seal fittings are identical with EZD drain seals
- Provides all inspection, maintenance and installation advantages, except that the cover is not provided with an automatic drain. Water accumulations can be drained periodically by removing the cover. The cover must be replaced immediately.
- Sealing fittings with an "X" at the end of the part number indicate Expanded Fill Hubs, that have a 40% wire fill capacity

Sealing Compounds

Plasti-Bond REDH₂OT sealing fittings must be used with a suitable system of sealing compound, as required by UL Listing, such as Chico® A, Chico X or Chico A-P from Crouse-Hinds. Chico SpeedSeal™ is rated for use in only Class I, Group C & D or lower classified hazardous locations and may be used for EYS or EYD sealing fittings (sizes 1/2" - 2"). Follow the installation instructions included with the sealing compound products and properly tag after installation to ensure correct classification ratings.

CATALOG #	PART DESCRIPTION
SHCHICOA3	Chico A Powder (1 lb)
SHCHICOA4	Chico A Powder (1 lb)* w/ Chico X fiber included
SHCHICOA5	Chico A Powder (5 lb)
SHCHICOA19PX	Chico A-P Intrapak Pre-Mixed packs (5 Cu In)
SHCHICOA39PX	Chico A-P Intrapak Pre-Mixed packs (11 Cu In)
SHCHICOX4	Chico X Fiber (2 oz)
SHCHICOX6	Chico X Fiber (8 oz)
SHCHICOX7	Chico X Fiber (1 lb)
SHCHICOSS2	Chico SpeedSeal (2 oz Cartridge)
SHCHICOSS6	Chico SpeedSeal (6 oz Cartridge)



System Safety in Hazardous Locations

To maintain the highest level of ongoing protection, it is critical that raceways incorporate a complete system of Plasti-Bond conduits and fittings. In hazardous locations, threads of all raceway components are designed to act as a pathway that allows an internal explosion to cool and escape into the outside atmosphere without exploding externally. Plasti-Bond conduit ensures a level performance with proven processes; such as the automated Pro-Tech™ hot-galvanizing system to guarantee a consistent coating thickness, providing proper fit and unsurpassed corrosion protection.

- In a coated system, only Plasti-Bond Coated Conduit and Couplings are UL Listed for use with Plasti-Bond hazardous location fittings.
- For installation instructions, reference IF sheets (Installation and Maintenance) that are supplied with each product ordered.

P5SA™ Validation System

Our patent-pending P5SA™ validation system, available on Plasti-Bond sealing fittings, gives additional assurance to both installers and inspectors that the urethane coated plugs are correctly engaged the first time, every time by means of visual confirmation. When the plug is properly engaged, it will not protrude beyond the beveled edge of the PVC around the plug, validating that there are 5 full threads of engagement per the NEC code, which is critical for safe installation and a proper flame path.

Installer Certification

Proper installation is essential to ensure the best possible service life for a conduit system. To ensure the best possible PVC-coated conduit installation, it is recommended that installers also be certified.

Plasti-Bond Installer Certification is based upon training that includes classroom and hands-on instruction encompassing:

- Proper installation techniques and tools
- Hands-on instruction for clamping, cutting, threading, bending and assembly of PVC-coated conduit
- System assembly and best practices
- Interactive discussion of techniques and troubleshooting

Only installers who are able to present the authorized, unexpired credentials of having passed our instruction and examination are officially certified to install Plasti-Bond's top-quality products.

There is no charge for installer certification, and it is available wherever it is convenient for you – job site, contractor's shop or factory! If you are a specifier, it is recommended to include installer certification as part of your expectations for your next PVC-coated project. For more information about Installer Certification, contact Plasti-Bond at (903) 843-5591.

Plasti-Bond REDH₂OT Certified Installer

ON , 20

NAME

successfully completed the Installer Certification Exam and is hereby designated a Certified Installer for PVC coated conduit.

SIGNED

EXPIRATION DATE

CERTIFIED

PB000000

1100 US Highway 271 South, Gilmer, TX 75644 • Tel: (903) 843-5591 • Fax: (903) 843-5595 • PlastiBond.com

Tools and Resources

Spin-It

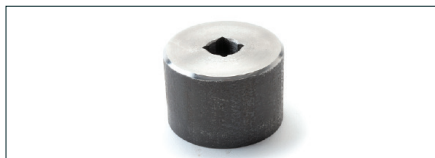

With the Spin-It, Plasti-Bond REDH₂OT can be tightened much faster than with conventional tools. Because the Spin-It never touches the coating, damage to the conduit is eliminated.

CATALOG #	DESCRIPTION
SPSPIN-IT-3/4	3/4" Spin-It
SPSPIN-IT-1	1" Spin-It
SPSPIN-IT-1-1/4	1-1/4" Spin-It
SPSPIN-IT-1-1/2	1-1/2" Spin-It
SPSPIN-IT-2	2" Spin-It

Plasti-Socket



Plasti-Socket is a fiber-glass encapsulated 3/8" drive socket for use with the square fiberglass encapsulated U bolt and beam clamp nuts used in the Plasti-Bond REDH₂OT conduit support system. The Plasti-Socket helps avoid coating damage from metal sockets, pliers or wrenches.

CATALOG #	DESCRIPTION
PSPLASTISOCKET-3/8	3/8" Plasti-Socket

Z-Wrench



Z-Wrench features extra wide jaws that spread the clamping force, enabling the tool to grip without marring the surface of the conduit. The "V" shaped upper jaw allows Z-Wrench to accommodate a wide range of conduit sizes. Shallow grooves in the upper and lower jaws provide an excellent grip.

CATALOG #	DESCRIPTION
SPJPZ1	1/2"-1-1/4" Z-Wrench
SPJPZ2	1-1/2"-2-1/2" Z-Wrench

JAWS 3



JAWS 3 are a set of aluminum-nickel-bronze vise jaws designed to replace the regular jaws in a RIGID #23 or #40-A pipe vise. They completely protect the exterior coating from damage caused by the vise jaws when cutting or threading.

CATALOG #	DESCRIPTION
JWJAWS3-#23	JAWS3 #23 Pipe Vise
JWJAWS3-#40-A	JAWS3 #40-A Tripod Pipe Vise

Half-Shell Clamps



Half-Shell Clamps are designed to cover a large surface area when clamping conduit, especially in a chain vise. This allows for a strong grip without damaging the exterior coating.

CATALOG #	DESCRIPTION
JWHLF-SHL-CLP2	2" Half-Shell Conduit Clamp
JWHLF-SHL-CLP2-1/2	2-1/2" Half-Shell Conduit Clamp
JWHLF-SHL-CLP3	3" Half-Shell Conduit Clamp
JWHLF-SHL-CLP3-1/2	3-1/2" Half-Shell Conduit Clamp
JWHLF-SHL-CLP4	4" Half-Shell Conduit Clamp
JWHLF-SHL-CLP5	5" Half-Shell Conduit Clamp
JWHLF-SHL-CLP6	6" Half-Shell Conduit Clamp

Hickey



The Plasti-Bond Hickey is a special bending tool with a 40 mil PVC coating that reduces the possibility of damage during conduit bending.

CATALOG #	DESCRIPTION
PBHICKEY	1/2" & 3/4" Conduit Bender

PVC Coating Repair Kit



The PVC Coating Repair Kit is a UL recognized two-part epoxy capable of bonding to PVC and steel or aluminum substrates. It includes all necessary tools in order to repair the damaged area and is dark gray in color.

CATALOG #	DESCRIPTION
PBPVCREPAIR-KIT	PVC Coating Repair Kit

Touch-Up Compounds

Plasti-Bond REDH₂OT Touch-Up Compounds are available to repair minor damage to the interior urethane or exterior PVC factory coatings. The exterior PVC touch-up compound is gray and available in a 12 oz. aerosol can and a pint can with brush-top applicator. The approved thread compound is available in a pint can with a brush-top applicator.



CATALOG #	DESCRIPTION	SIZE
PBTOUCHUP-SPRAY	Exterior Spray Type (Gray)	12 oz.
PBTOUCHUP-GRAY-PT	Exterior Non-Spray with Brush-Top (Gray)	1 pt.
PBTHREAD-COMPOUND	Approved Conductive Compound-Brush-Top Pint	1 pt.

Plasti-Bond REDH₂OT[®]

Executive Offices:

1100 US Highway 271 South
Gilmer, TX 75644
Phone: (903) 843-5591
Fax: (903) 843-5595
Sales Fax: (903) 680-4259

CustomerService@PlastiBond.com



Plasti-Bond PVC-coated galvanized rigid conduit and fittings provide unequalled corrosion protection. Manufactured in the U.S.A., ISO 9001:2015 certified Plasti-Bond complies with all standards mandated by UL6, NEMA RN-1 and ANSI C80.1. In addition, Plasti-Bond is ETL-Verified for product performance and reliable longevity ten or more times longer than brands that are not ETL-Verified. Look for the combined ETL/UL label to be sure you are receiving the protection you've paid for.