

### Form 8 Fittings

## 2 INCH FORM 8 LL CONDUIT BODY



<b>Catalog Number</b>	PRHLL68
<b>UPC</b>	784011203789

### Description

PVC coated Form 8 conduit bodies with covers are offered in numerous configurations to provide a complete coated conduit system. Electrical continuity of the conduit system is maintained across assembled joints.

### Additional Product Description

Conduit bodies connect sections of conduit and provide for access to conductors for maintenance and future system changes. They may be used for pull outlets for conductors being installed or to provide openings for making taps or splices in conductors or to make 90 degree bends.

### Application

- Offered in numerous configurations for 90 degree bends, taps or splices or mounting outlets

### Features

- 40 mil gray PVC exterior coating
- 2 mil red urethane interior coating
- 10 trade sizes from 1/2" through 4"
- Sealing sleeves on all conduit openings
- Plastic encapsulated stainless steel screws with retainers built into covers for trade sizes 1/2" through 2"
- V-Seal gasket on sizes 1/2" through 4"

### General Information

Trade Size	2
Material	FERROUS METAL
Material	FERROUS METAL
Exterior Finish	A nominal .040 inch (40 mil) gray PVC coating

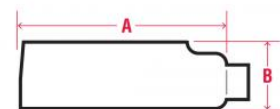
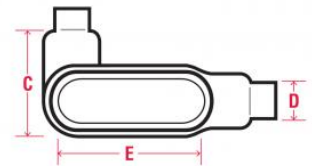

Interior Finish	A nominal .002 inch (2 mil) red urethane
Body Style	LL
Screw Type	Plastic encapsulated stainless steel cover screws with retainers
Cover Seal	V-Seal gasket

## Dimensions

Dimension A (Inches)	11.04
Dimension B (Inches)	3.6
Dimension C (Inches)	5.04
Dimension D (Inches)	3
Dimension E (Inches)	8.56
Nominal Weight (Pounds)	10.5

## Standards

CSA Certified	C22.2 No. 42
CSA Certified	C22.2 No.18
IEC IP69	E489286
UL 514A, 514D	E231035
UL Type 4X	E231035

## Technical Specification Documents

Specification Guide (1995 Master)	AVAILABLE ON WEBSITE
Specification Guide (2004 Master)	AVAILABLE ON WEBSITE
Installer Certification and Tools	AVAILABLE ON WEBSITE
Chemical Resistance Charts	AVAILABLE ON WEBSITE
Performance Specifications	AVAILABLE ON WEBSITE

## Technical Information

Conduit Body	LL
Fitting Type	FORM 8

Product Category

FITTING

Product Family

Form 8 Fittings

**Notes**

---

- All cover screws are stainless steel