

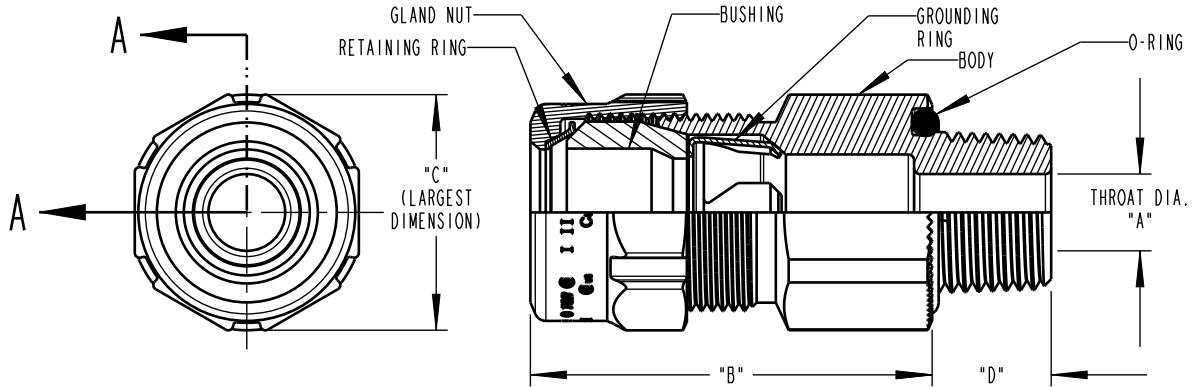

# T&B Fittings



### CERTIFICATIONS



CLASS I, CLASS II GROUP EFG, CLASS III  
Ex E IIC  
CLASS I, Zone I, AEx E II



LISTED FOR METAL CLAD CABLES (TYPE MC)  
SUITABLE FOR CLASS I, II, III DIV 2 PER NEC

TYPE 4X: ALUMINUM & STAINLESS STEEL  
TYPE 4: ZINC PLATED STEEL

### MATERIAL:

- BODY & GLAND NUT = ALUMINUM
- GROUNDING & RETAINING RINGS = STAINLESS STEEL
- BUSHING: SILICONE (ST050 to ST150) or NEOPRENE (ST200 to ST400)
- O-RING: NITRILE

### NOTES:

1. ADD SUFFIX "SS" ON CATALOG NUMBER FOR A STAINLESS STEEL BODY & GLAND (CONTACT YOUR SALES REPRESENTATIVE FOR AVAILABILITY).
2. ADD SUFFIX "S" ON CATALOG NUMBER FOR A ZINC PLATED STEEL BODY AND GLAND

CATALOG No.	HUB SIZE (NPT)	RANGE OVER JACKET (inches)		RANGE OVER ARMOR (inches)		THROAT DIA. MIN. (inches) "A"	OVERALL (inches) "B"	ACROSS CORNERS (inches) "C"	NPT THREAD LENGTH (inches) "D"
		MINIMUM	MAXIMUM	MINIMUM	MAXIMUM				
ST050-462	1/2-14	0.525	0.650	0.415	0.570	0.395	2.02	1 11/32	0.620
ST050-464	1/2-14	0.600	0.760	0.505	0.680	0.485	2.02	1 11/32	0.620
ST050-465	1/2-14	0.725	0.885	0.632	0.805	0.612	2.13	1 21/32	0.620
ST050-466	1/2-14	0.825	0.985	0.632	0.905	0.612	2.13	1 21/32	0.620
ST075-467	3/4-14	0.880	1.065	0.834	0.985	0.814	2.45	2 3/32	0.630
ST075-468	3/4-14	1.025	1.205	0.834	1.125	0.814	2.45	2 3/32	0.630
ST100-469	1-11 1/2	1.187	1.375	1.063	1.295	1.043	2.60	2 7/16	0.785
ST125-470	1 1/4-11 1/2	1.350	1.625	1.202	1.545	1.182	3.28	3	0.810
ST125-550	1 1/4-11 1/2	1.500	1.625	1.390	1.545	1.370	3.28	3	0.810
ST125-471	1 1/4-11 1/2	1.600	1.875	1.390	1.795	1.370	3.28	3	0.810
ST150-472	1 1/2-11 1/2	1.700	1.965	1.577	1.885	1.557	3.62	3 7/16	0.825
ST150-473	1 1/2-11 1/2	1.900	2.187	1.620	2.107	1.600	3.62	3 7/16	0.825
ST200-551	2-11 1/2	1.900	2.187	1.735	2.107	1.715	3.64	3 13/16	0.860
ST200-474	2-11 1/2	2.100	2.375	2.015	2.280	1.995	3.64	3 13/16	0.860
ST200-475	2-11 1/2	2.300	2.565	2.077	2.485	2.057	3.64	4 3/16	0.860
ST200-476	2-11 1/2	2.500	2.750	2.077	2.656	2.057	3.64	4 3/16	0.860
ST250-477	2 1/2-8	2.380	2.640	2.281	2.560	2.261	4.70	4 25/32	1.280
ST250-478	2 1/2-8	2.580	2.840	2.481	2.750	2.461	4.70	4 25/32	1.280
ST300-479	3-8	2.790	3.060	2.683	2.970	2.661	4.70	5 3/32	1.340
ST300-480	3-8	3.000	3.270	2.912	3.190	2.890	4.79	5 1/2	1.340
ST300-481	3-8	3.210	3.480	3.084	3.390	3.062	4.79	5 1/2	1.340
ST350-482	3 1/2-8	3.420	3.690	3.308	3.590	3.290	4.79	6 1/32	1.390
ST350-483	3 1/2-8	3.610	3.870	3.481	3.770	3.460	4.79	6 1/32	1.390
ST400-484	4-8	3.810	4.030	3.654	3.930	3.630	4.84	6 9/16	1.440
ST400-485	4-8	3.965	4.185	3.799	4.065	3.775	4.84	6 9/16	1.440
ST400-486	4-8	4.120	4.340	3.964	4.220	3.940	4.84	6 9/16	1.440

### GENERAL NOTES

1. ALL DIMENSIONS ARE FOR REFERENCE ONLY.
2. DIMENSIONS IN BRACKETS [ ] ARE IN METRIC UNITS.

www.tnb.com

**Thomas & Betts**  
A Member of the ABB Group

### REVISIONS

SEE ERN ( ) FOR APPROVAL SIGNATURES & RELEASE DATE.  
PROJECT NO:

DESCRIPTION:

**STARTECK CABLE CONNECTOR**  
**1/2" @ 4" SIZE**

ORIGINAL PROJECT NO / ECN NO

RM401886 / ( 2017100 )

SHEET NO:

1 OF 1

REV. NO:

C

DRAWING NO:

WSD-001617